

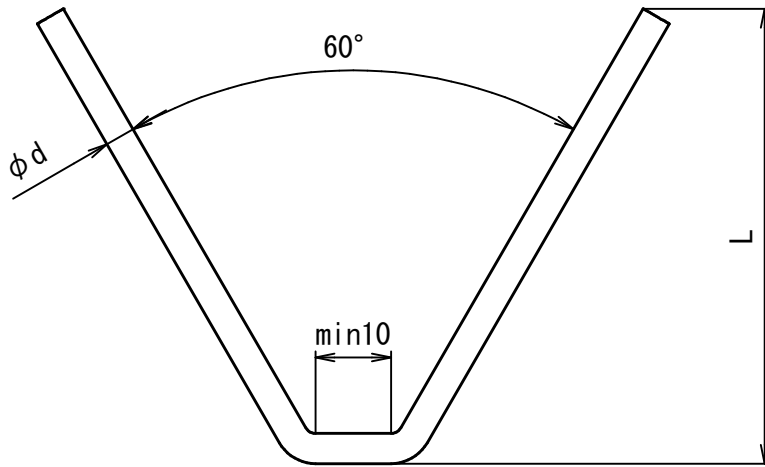

# VB Anchor

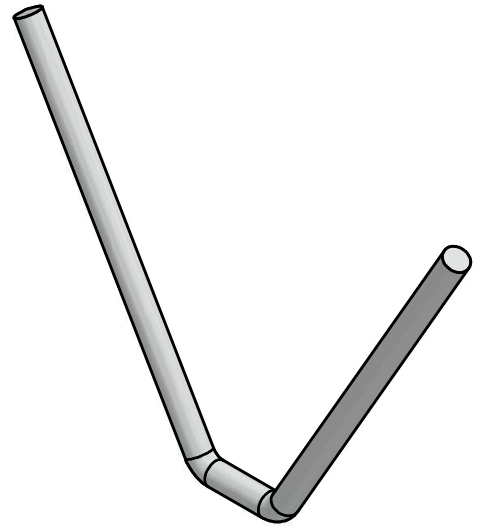
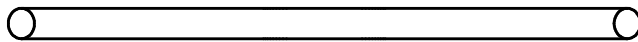

### Note

- The number of bends of the waves depends on the L dimension
- Options attached to the top CAPS or COATING

Client		Item		
		60-VB-d-L		
Delivery		DWG No.		Date
				2020/06/01
	Appd. 西野	Drawn 中岡	Material	Qty.
		<b>Namitakiko Co.,Ltd.</b>		



# VB2 Anchor

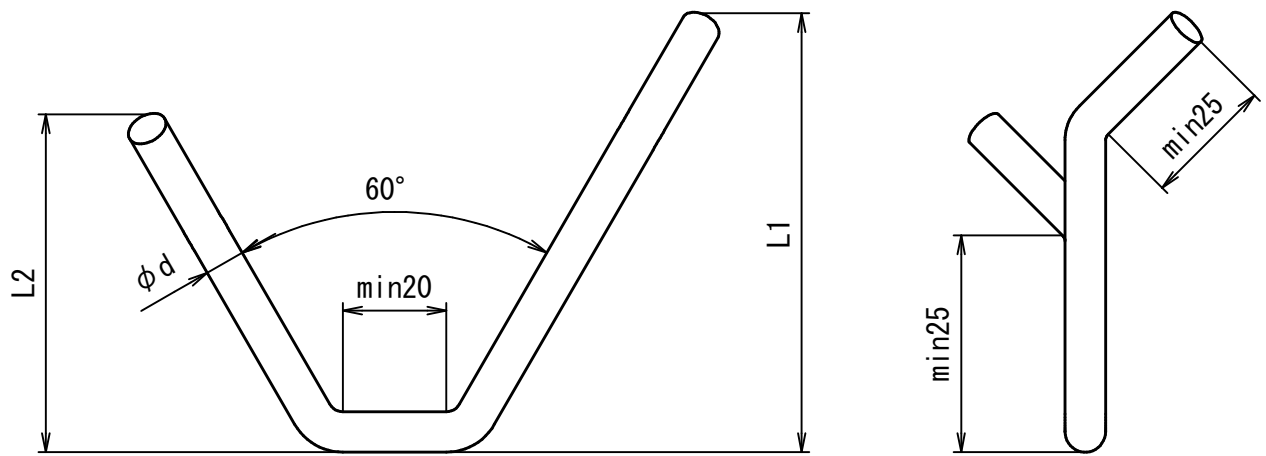
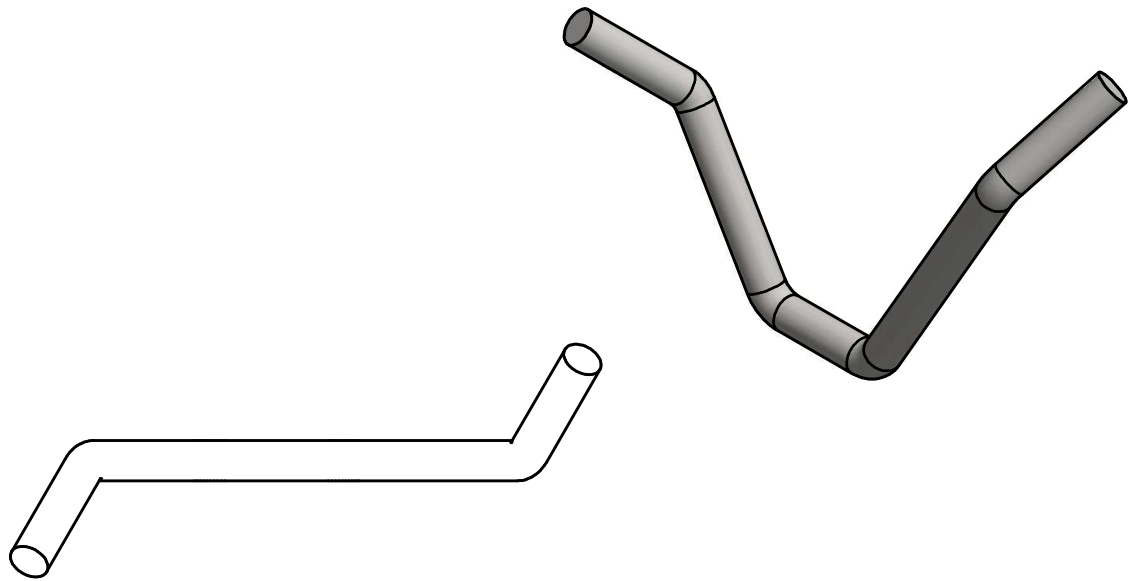

### Note

- The number of bends of the waves depends on the L dimension
- Options attached to the top CAPS or COATING

Client		Item		
		60-VB2-d-L1-L2		
Delivery		DWG No.		Date
				2020/06/01
	Appd. 西野	Drawn 中岡	Material	Qty.
		<b>Namitakiko Co.,Ltd.</b>		



# VBS Anchor

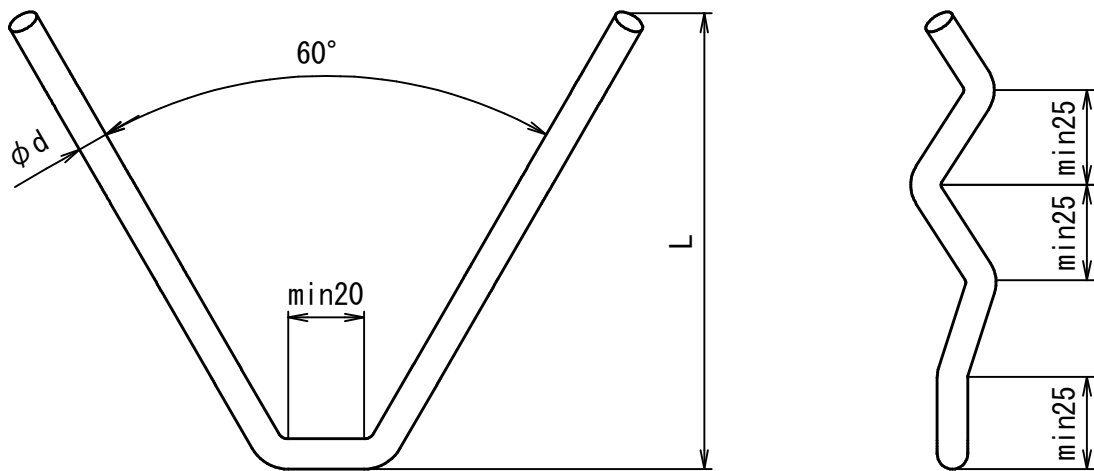
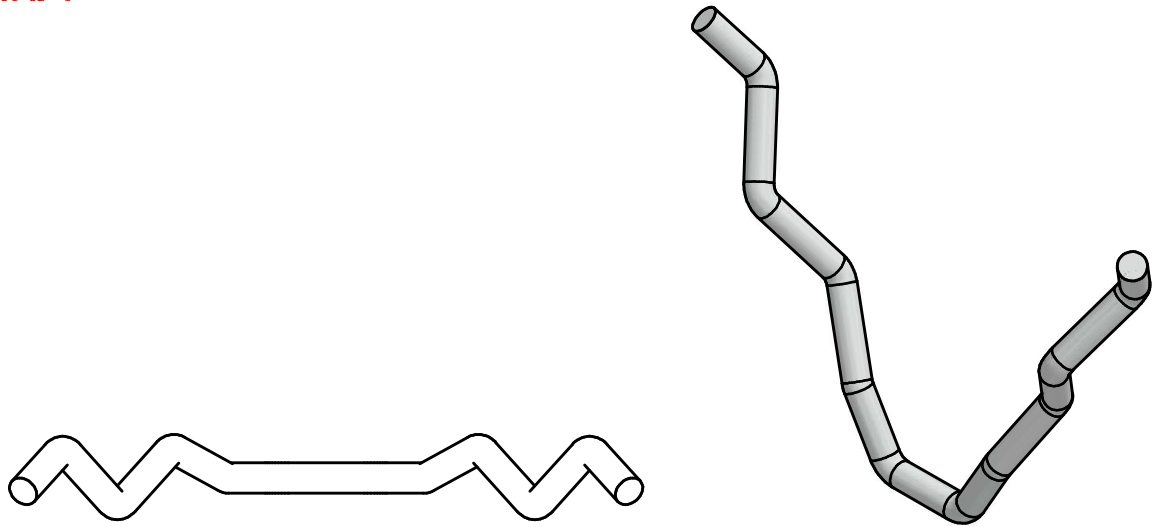

### Note

- The number of bends of the waves depends on the L dimension
- Options attached to the top CAPS or COATING

Client		Item <b>60-VBS-d-L</b>		
Delivery		DWG No.		Date 2020/06/01
	Appd. 西野	Drawn 中岡	Material	Qty.
		<b>Namitakiko Co.,Ltd.</b>		



# VBS1 Anchor

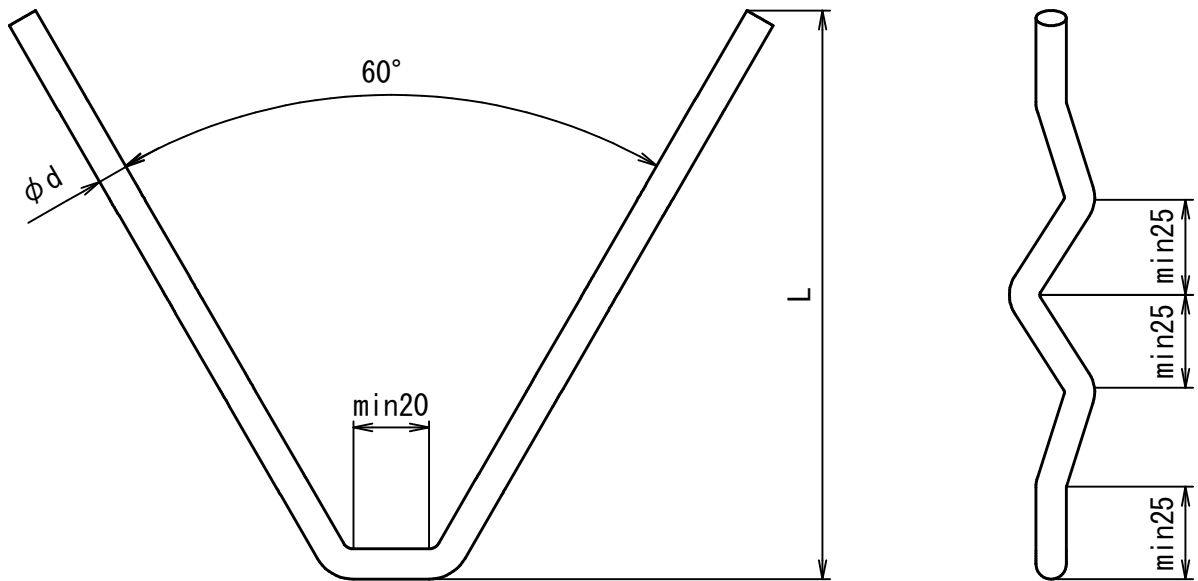
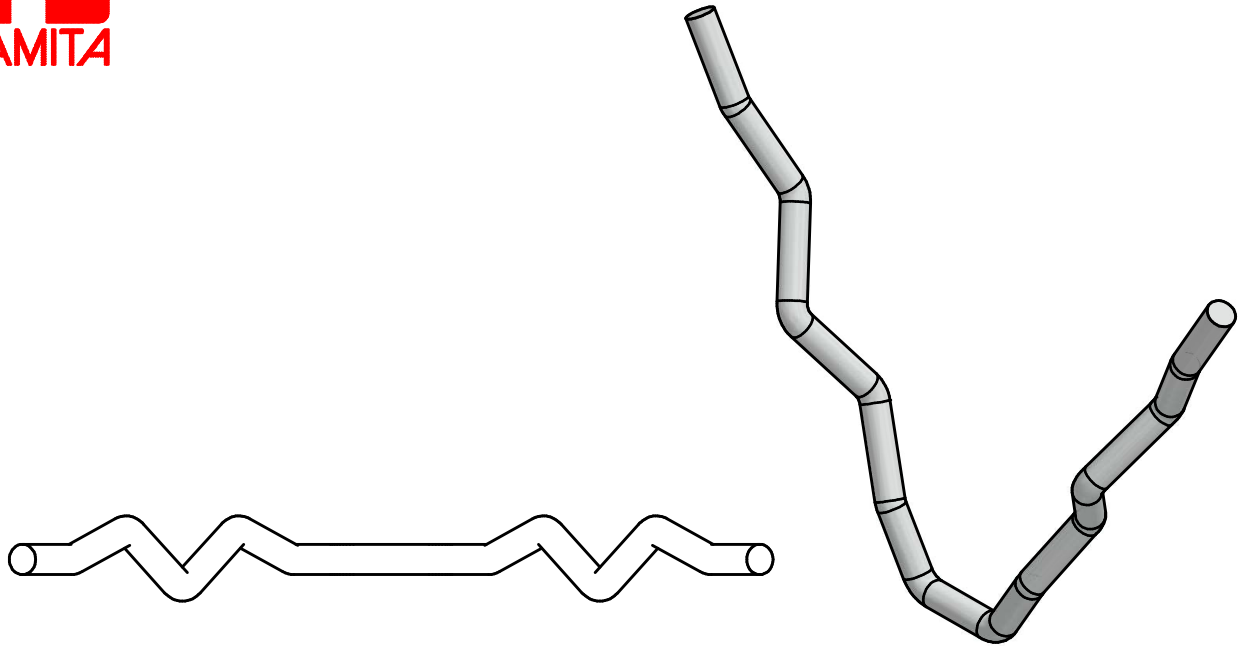

### Note

- The number of bends of the waves depends on the L dimension
- Options attached to the top CAPS or COATING

Client		Item		
		60-VBS1-d-L		
Delivery		DWG No.		Date
				2020/06/01
	Appd. 西野	Drawn 中岡	Material	Qty.
		<b>Namitakiko Co.,Ltd.</b>		



# VBR Anchor

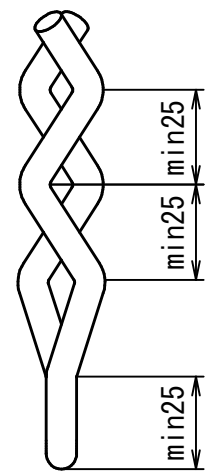
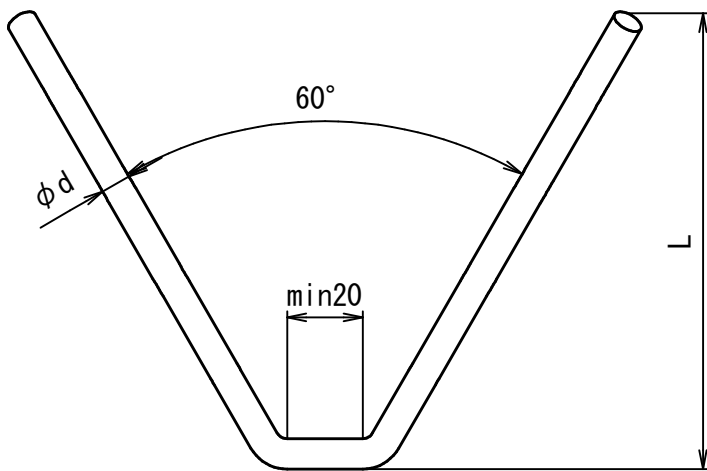
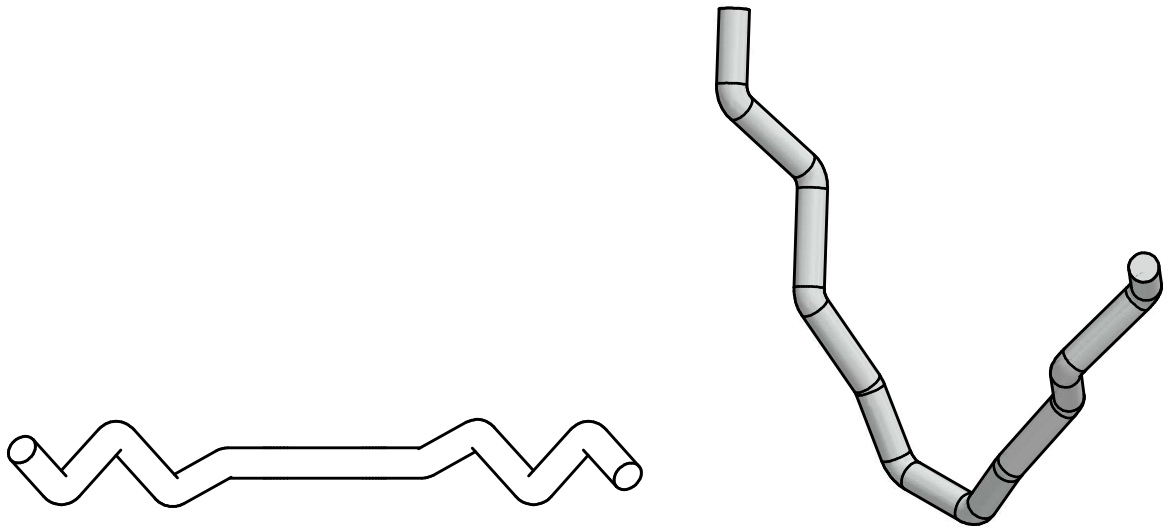

### Note

- The number of bends of the waves depends on the L dimension
- Options attached to the top CAPS or COATING

Client		Item <b>60-VBR-d-L</b>		
Delivery		DWG No.		Date 2020/06/01
	Appd. 西野	Drawn 中岡	Material	Qty.
			<b>Namitakiko Co.,Ltd.</b>	



# VBR1 Anchor

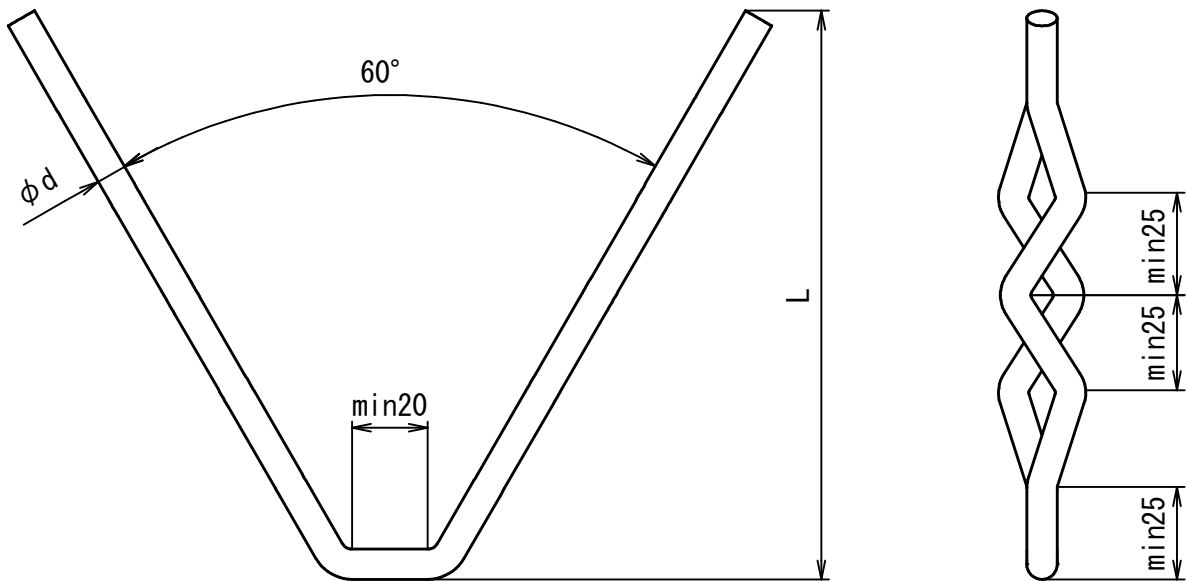
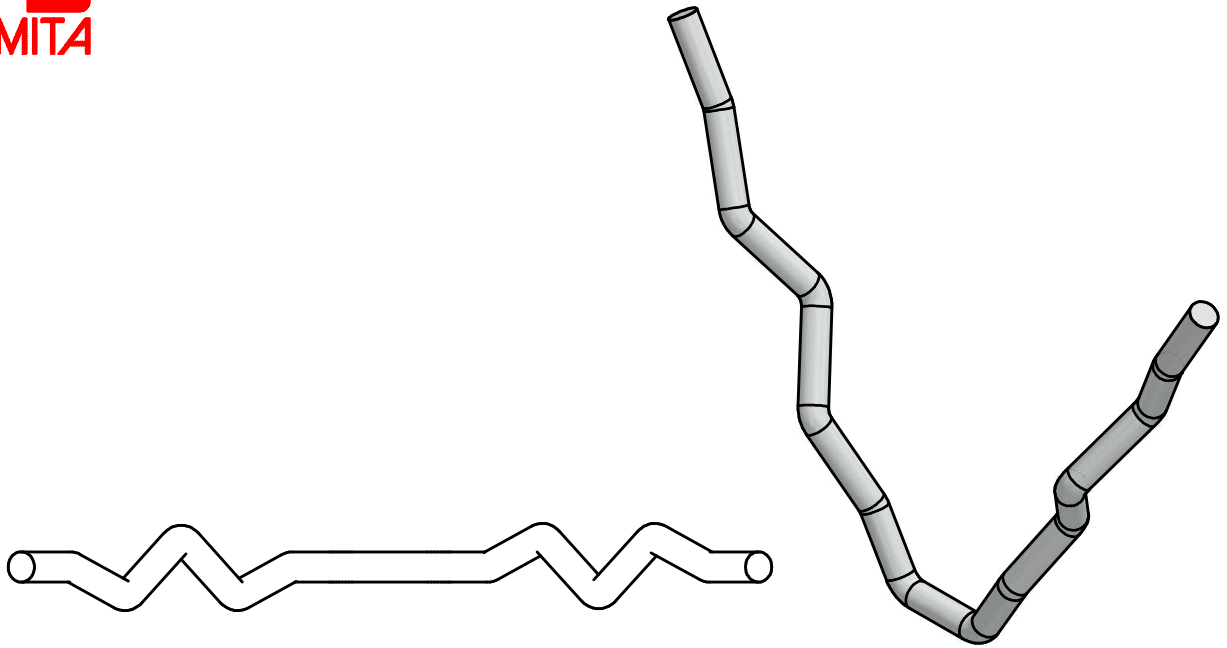

### Note

- The number of bends of the waves depends on the L dimension
- Options attached to the top CAPS or COATING

Client		Item		
		60-VBR1-d-L		
Delivery		DWG No.		Date
				2020/06/01
	Appd. 西野	Drawn 中岡	Material	Qty.
		<b>Namitakiko Co.,Ltd.</b>		



# VBF Anchor

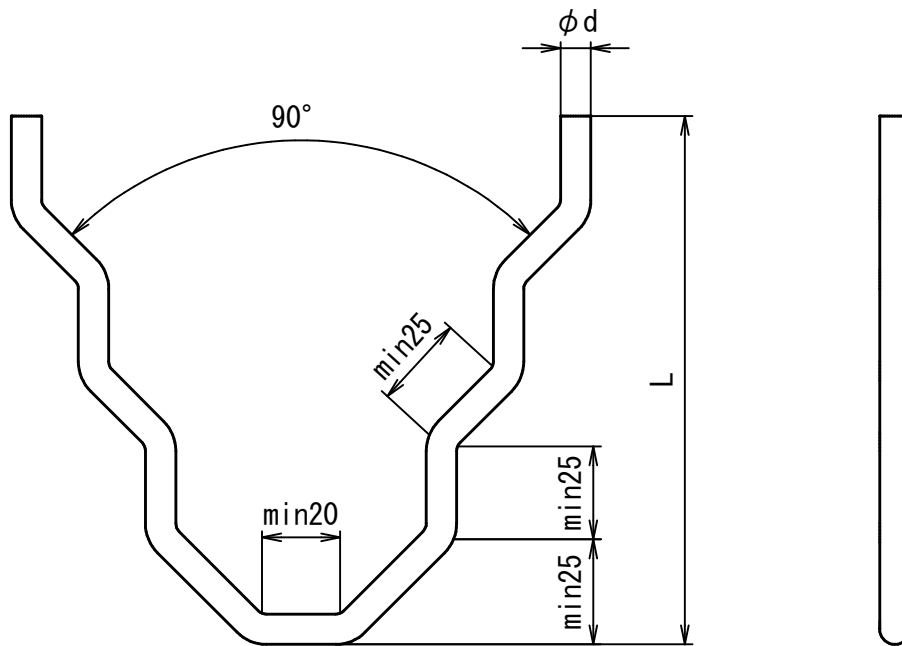
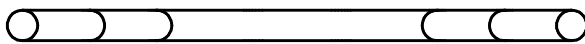
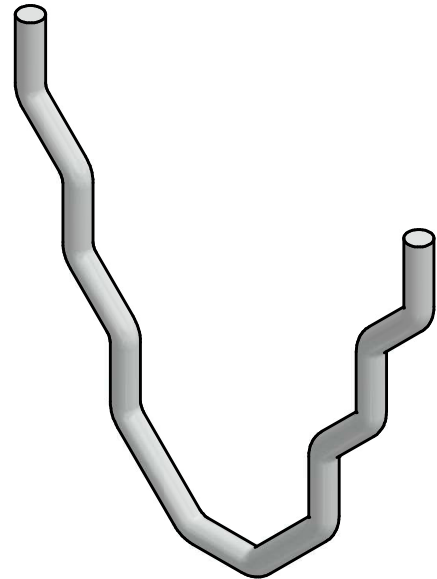

### Note

- The number of bends of the waves depends on the L dimension
- Options attached to the top CAPS or COATING

Client		Item		
		90-VBF-d-L		
Delivery		DWG No.		Date
				2020/06/01
	Appd. 西野	Drawn 中岡	Material	Qty.
		<b>Namitakiko Co.,Ltd.</b>		



# VL Anchor

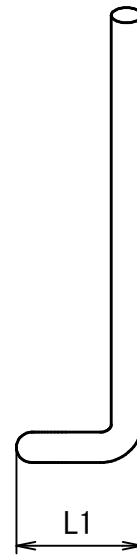
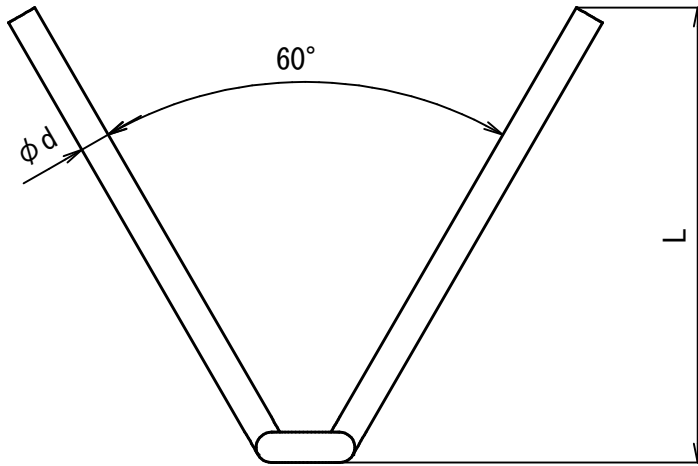
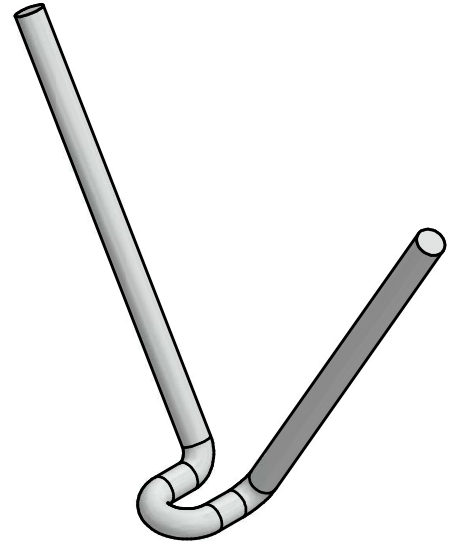
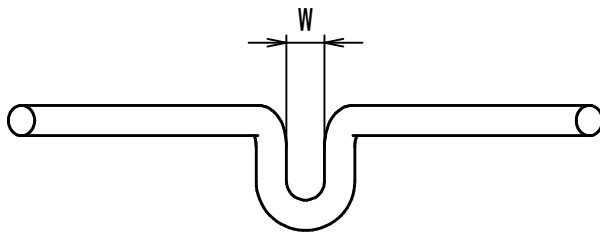

### Note

- The number of bends of the waves depends on the L dimension
- Options attached to the top CAPS or COATING

L1	min40	min40	min50	min50
W	10/13	10/20/25	25	25
$\phi d$	$\phi 6$	$\phi 8$	$\phi 9 / \phi 10$	$\phi 12$

Client		Item <b>60-VL-d-L</b>		
Delivery		DWG No.		Date 2020/06/01

	Appd. 西野	Drawn 中岡	Material	Qty.
--	-------------	-------------	----------	------



**Namitakiko Co.,Ltd.**





# VL2 Anchor

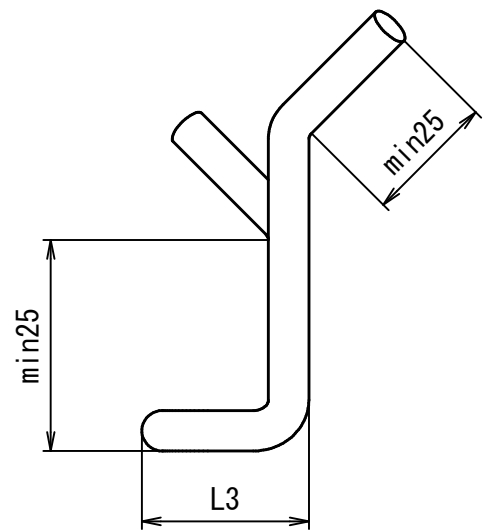
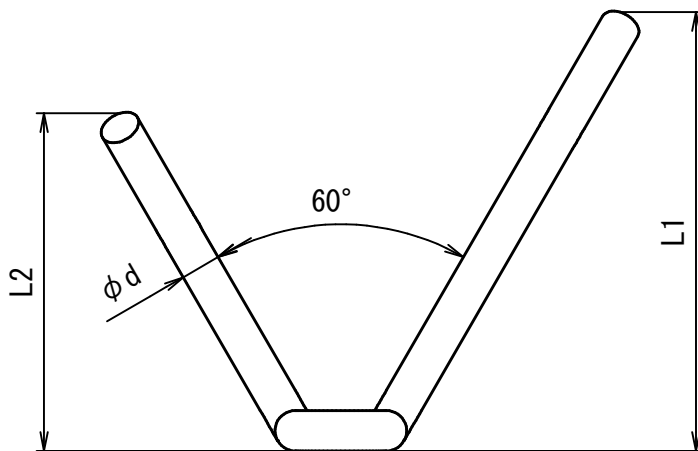
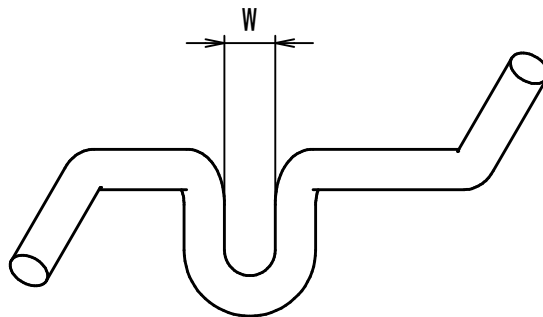
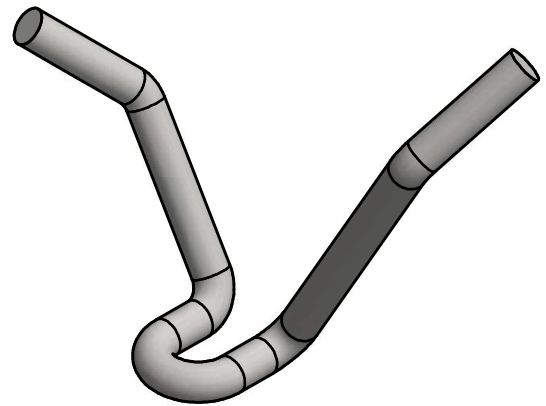

### Note

- The number of bends of the waves depends on the L dimension
- Options attached to the top CAPS or COATING

L3	min40	min40	min50	min50
W	10/13	10/20/25	25	25
$\phi d$	$\phi 6$	$\phi 8$	$\phi 9 / \phi 10$	$\phi 12$

Client		Item <b>60-VL2-d-L1-L2</b>		
Delivery		DWG No.		Date 2020/06/01

	Appd. 西野	Drawn 中岡	Material	Qty.
--	-------------	-------------	----------	------



**Namitakiko Co.,Ltd.**



# VLS Anchor

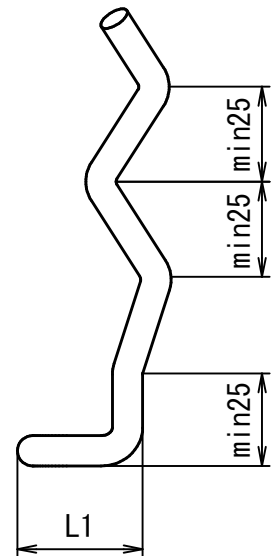
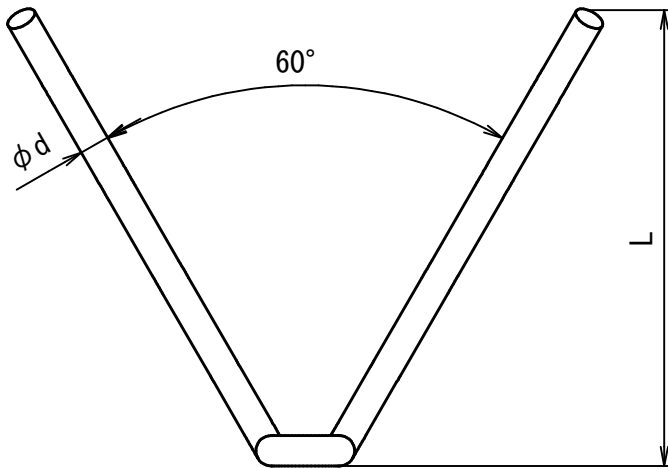
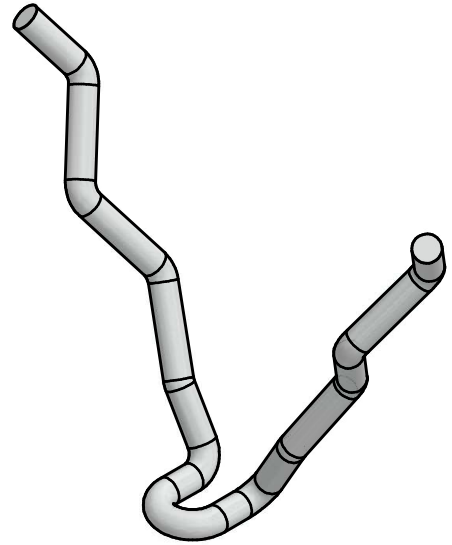
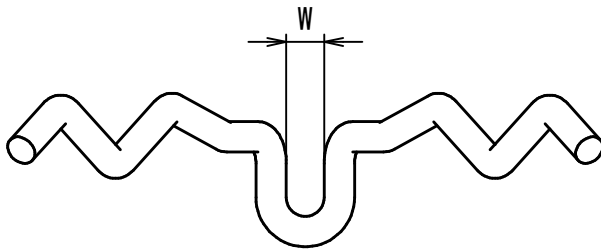

### Note

- The number of bends of the waves depends on the L dimension
- Options attached to the top CAPS or COATING

L1	min40	min40	min50	min50
W	10/13	10/20/25	25	25
$\phi d$	$\phi 6$	$\phi 8$	$\phi 9/\phi 10$	$\phi 12$

Client		Item <b>60-VLS-d-L</b>		
Delivery		DWG No.		Date 2020/06/01

	Appd. 西野	Drawn 中岡	Material	Qty.
--	-------------	-------------	----------	------



**Namitakiko Co.,Ltd.**



# VLS1 Anchor

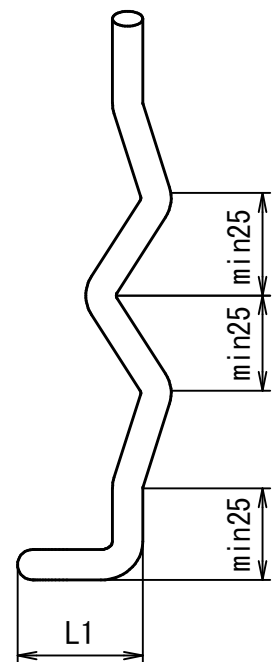
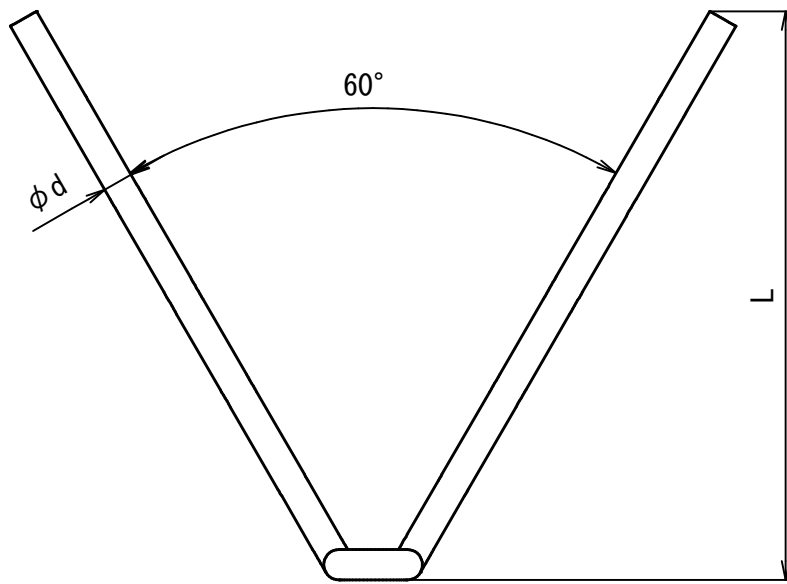
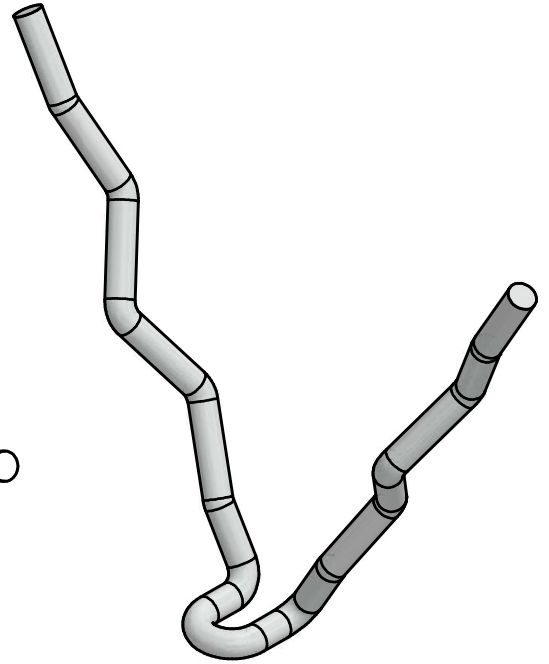
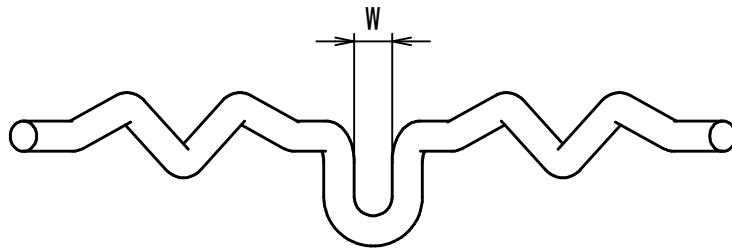

### Note

- The number of bends of the waves depends on the L dimension
- Options attached to the top CAPS or COATING

L1	min40	min40	min50	min50
W	10/13	10/20/25	25	25
$\phi d$	$\phi 6$	$\phi 8$	$\phi 9/\phi 10$	$\phi 12$

Client

Item  
**60-VLS1-d-L**

Delivery

DWG No.

Date  
2020/06/01

	Appd. 西野	Drawn 中岡	Material	Qty.
--	-------------	-------------	----------	------

**Namitakiko Co.,Ltd.**



# VLR Anchor

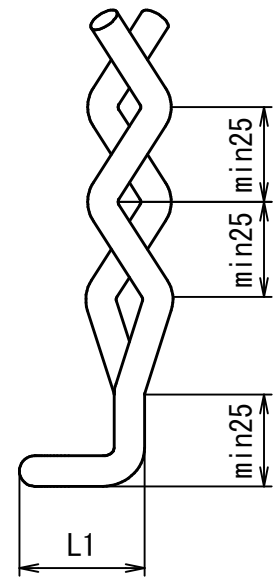
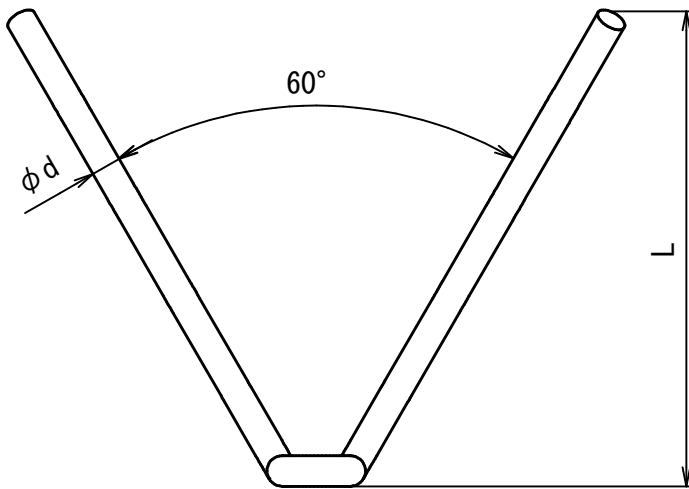
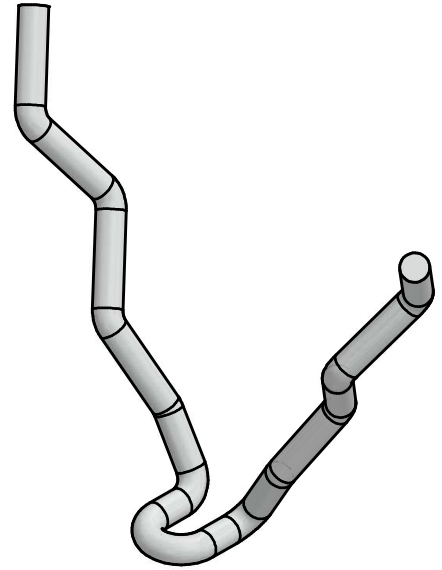
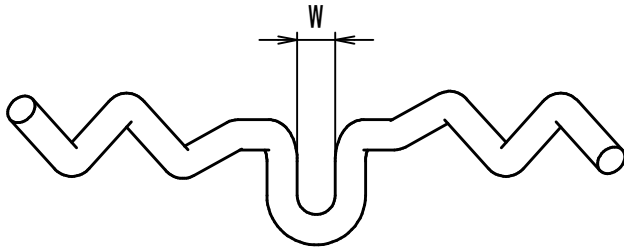

## Note

- The number of bends of the waves depends on the L dimension
- Options attached to the top CAPS or COATING

L1	min40	min40	min50	min50
W	10/13	10/20/25	25	25
$\phi d$	$\phi 6$	$\phi 8$	$\phi 9/\phi 10$	$\phi 12$

Client

Item  
**60-VLR-d-L**

Delivery

DWG No.  
Date  
2020/06/01

	Appd. 西野	Drawn 中岡	Material	Qty.
--	-------------	-------------	----------	------

**Namitakiko Co.,Ltd.**



# VLR1 Anchor

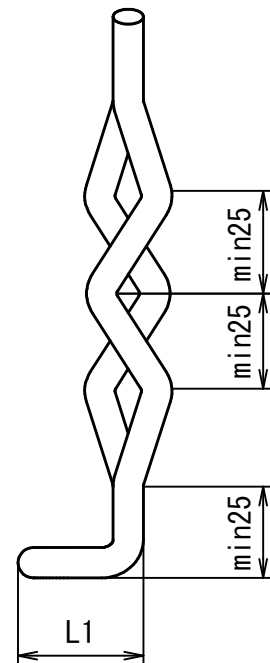
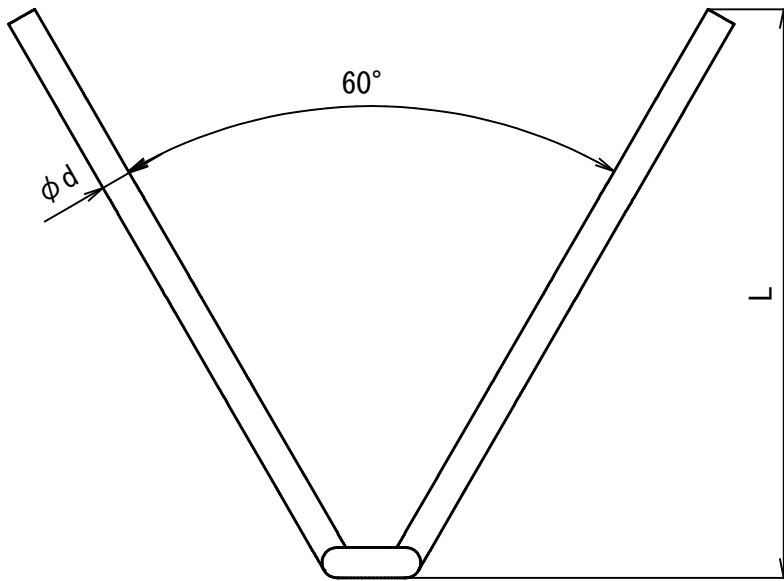
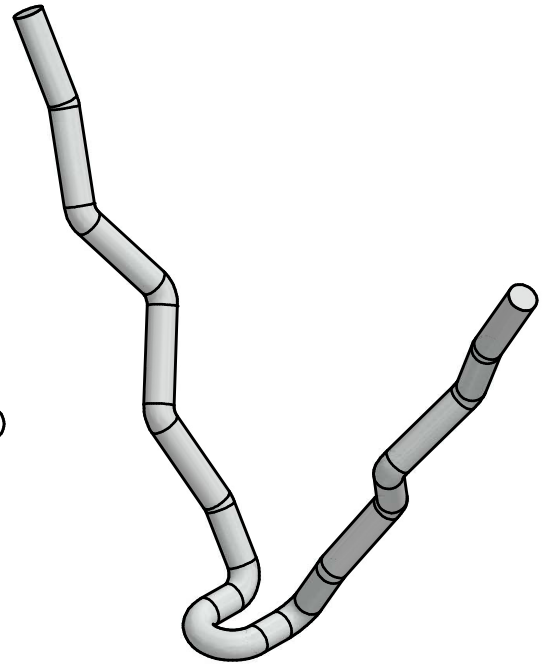
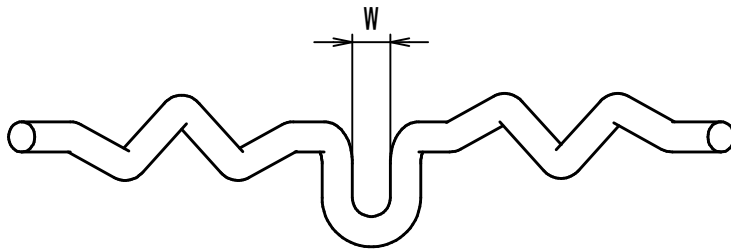

### Note

- The number of bends of the waves depends on the L dimension
- Options attached to the top CAPS or COATING

L1	min40	min40	min50	min50
W	10/13	10/20/25	25	25
$\phi d$	$\phi 6$	$\phi 8$	$\phi 9 / \phi 10$	$\phi 12$

Client		Item <b>60-VLR1-d-L</b>		
Delivery		DWG No.		Date 2020/06/01

	Appd. 西野	Drawn 中岡	Material	Qty.
--	-------------	-------------	----------	------



**Namitakiko Co.,Ltd.**



# VLF Anchor

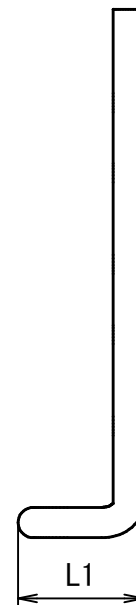
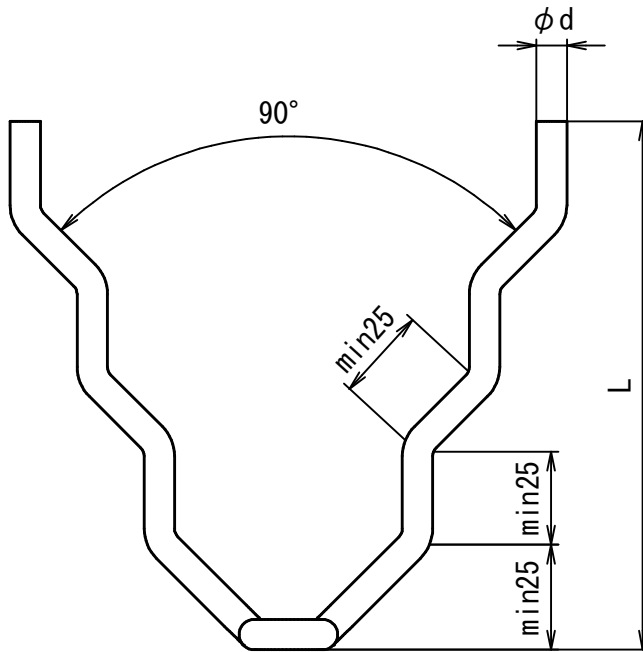
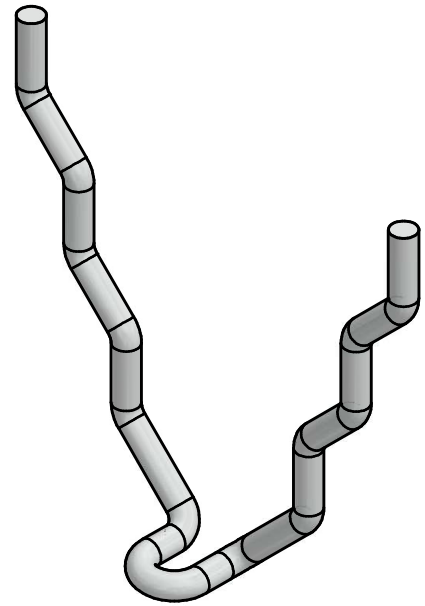
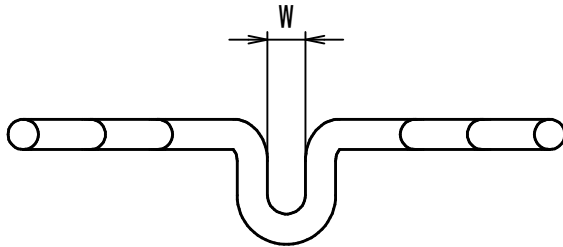

### Note

- The number of bends of the waves depends on the L dimension
- Options attached to the top CAPS or COATING

L1	min40	min40	min50	min50
W	10/13	10/20/25	25	25
$\phi d$	$\phi 6$	$\phi 8$	$\phi 9/\phi 10$	$\phi 12$

Client		Item <b>90-VLF-d-L</b>		
Delivery		DWG No.		Date 2020/06/01

	Appd. 西野	Drawn 中岡	Material	Qty.
--	-------------	-------------	----------	------



**Namitakiko Co.,Ltd.**



# VBC Anchor

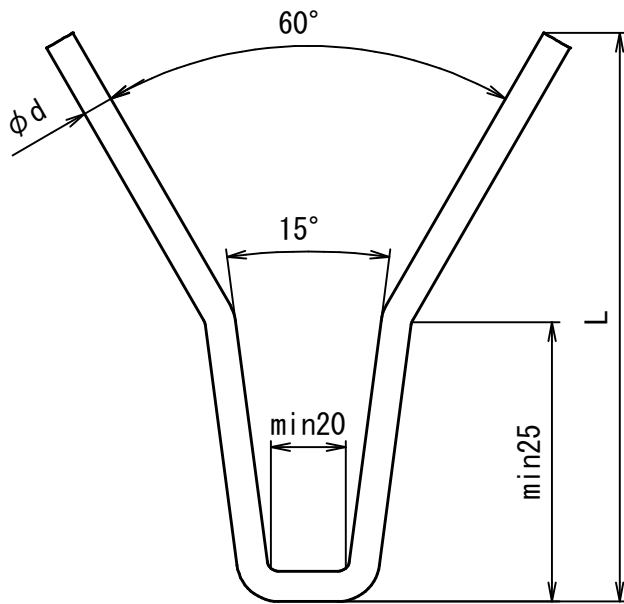
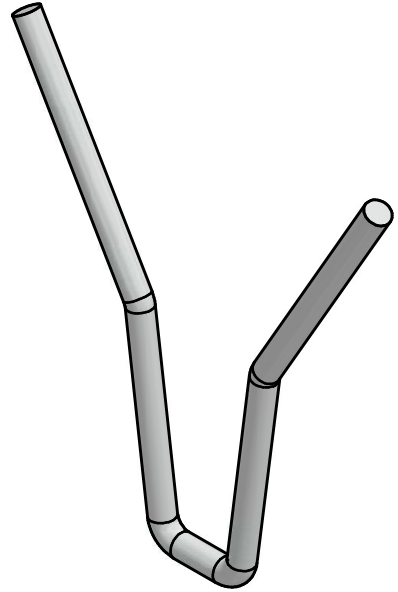
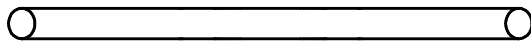

**Note**

- The number of bends of the waves depends on the L dimension
- Options attached to the top CAPS or COATING

Client		Item <b>60-VBC-d-L</b>		
Delivery		DWG No.		Date 2020/06/01
	Appd. 西野	Drawn 中岡	Material	Qty.
		<b>Namitakiko Co.,Ltd.</b>		



# VBCS Anchor

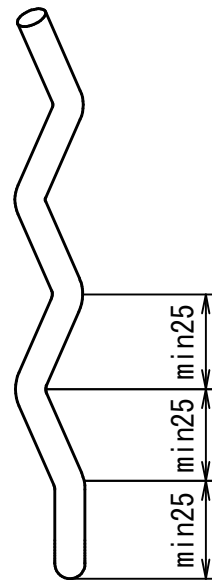
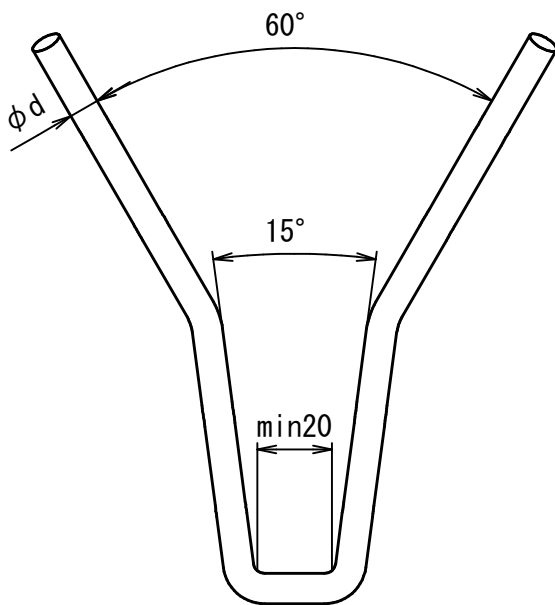
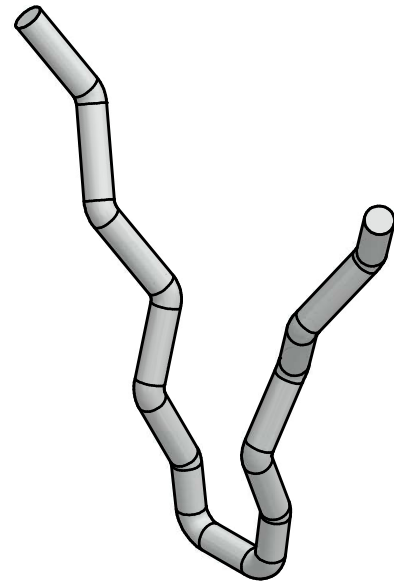
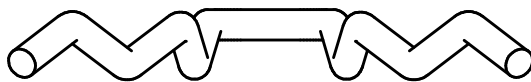

### Note

- The number of bends of the waves depends on the L dimension
- Options attached to the top CAPS or COATING

Client		Item		
		60-VBCS-d-L		
Delivery		DWG No.		Date
				2020/06/01
	Appd. 西野	Drawn 中岡	Material	Qty.
			<b>Namitakiko Co.,Ltd.</b>	





# VBCR Anchor

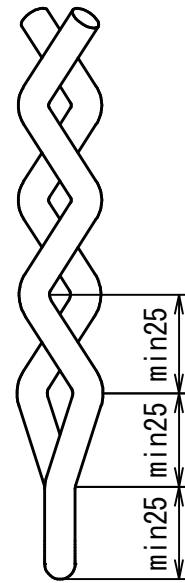
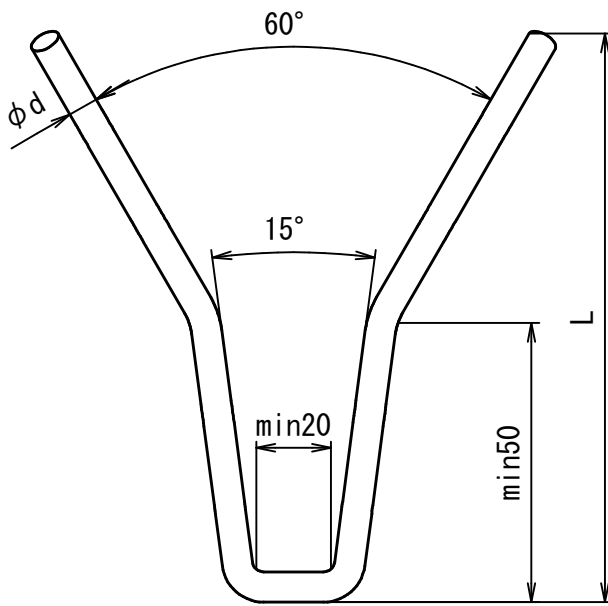
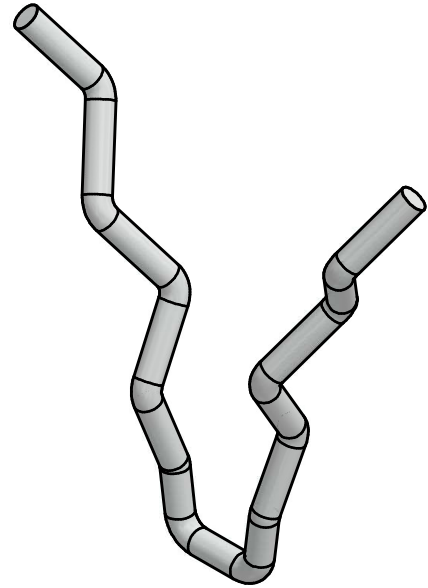
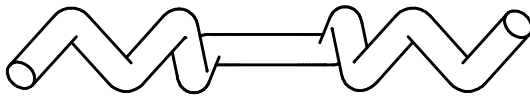

## Note

- The number of bends of the waves depends on the L dimension
- Options attached to the top CAPS or COATING

Client				Item <b>60-VBCR-d-L</b>	
Delivery				DWG No.	
				Date 2020/06/01	
	Appd. 西野	Drawn 中岡	Material	Qty.	<b>Namitakiko Co.,Ltd.</b>



# VLC Anchor

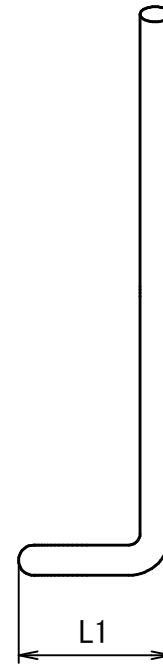
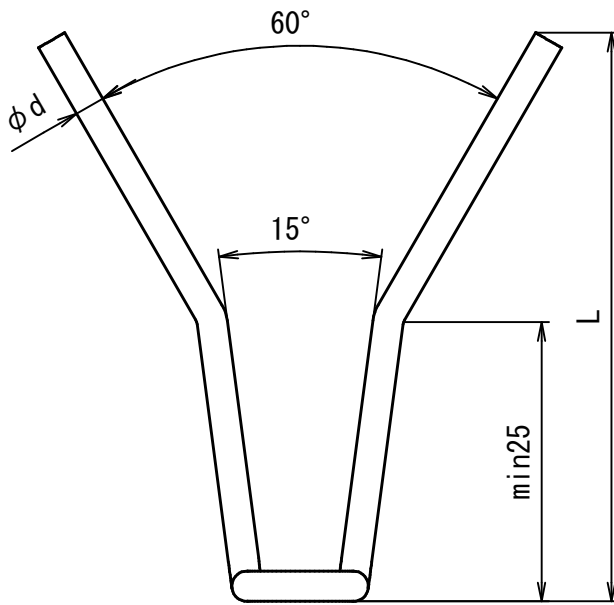
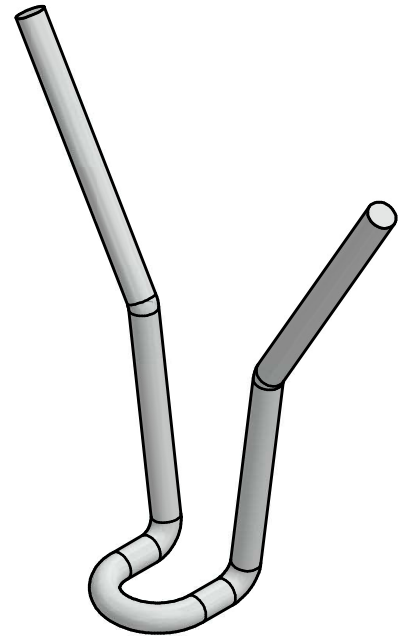
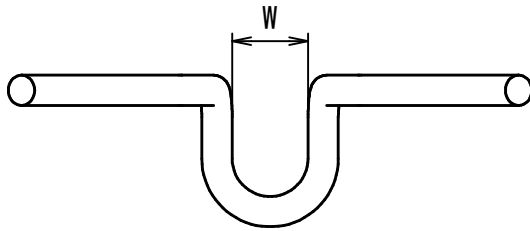

### Note

- The number of bends of the waves depends on the L dimension
- Options attached to the top CAPS or COATING

L1	min40	min40	min50	min50
W	10/13	10/20/25	25	25
$\phi d$	$\phi 6$	$\phi 8$	$\phi 9 / \phi 10$	$\phi 12$

Client

Item  
**60-VLC-d-L**

Delivery

DWG No.

Date  
2020/06/01

	Appd. 西野	Drawn 中岡	Material	Qty.
--	-------------	-------------	----------	------

**Namitakiko Co.,Ltd.**



# VLCS Anchor

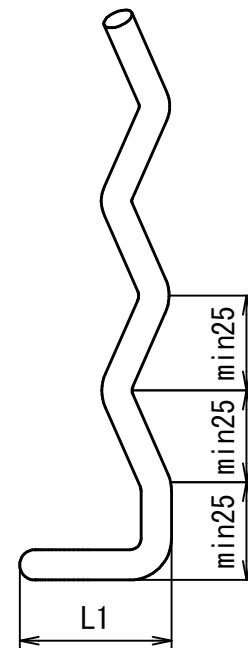
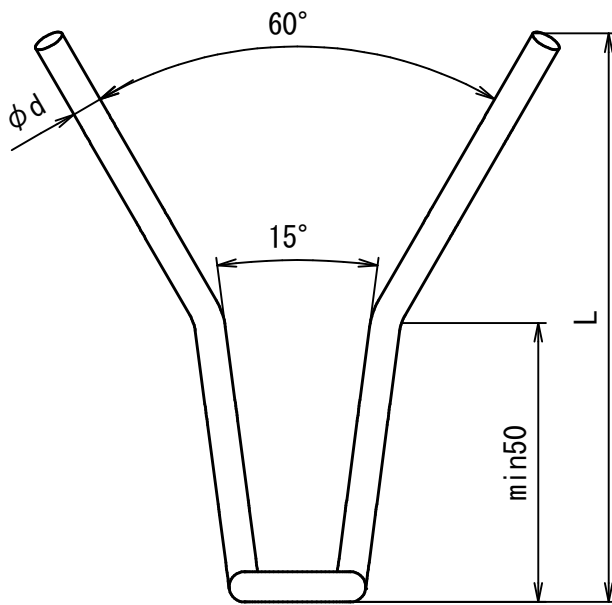
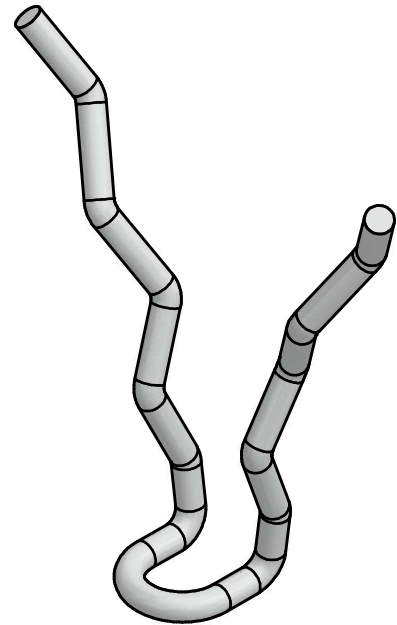
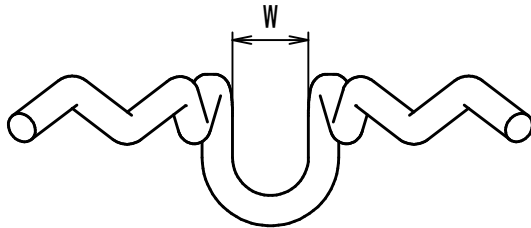

### Note

- The number of bends of the waves depends on the L dimension
- Options attached to the top CAPS or COATING

L1	min40	min40	min50	min50
W	10/13	10/20/25	25	25
$\phi d$	$\phi 6$	$\phi 8$	$\phi 9 / \phi 10$	$\phi 12$

Client		Item <b>60-VLCS-d-L</b>		
Delivery		DWG No.		Date 2020/06/01

	Appd. 西野	Drawn 中岡	Material	Qty.
--	-------------	-------------	----------	------



**Namitakiko Co.,Ltd.**



# VLCR Anchor

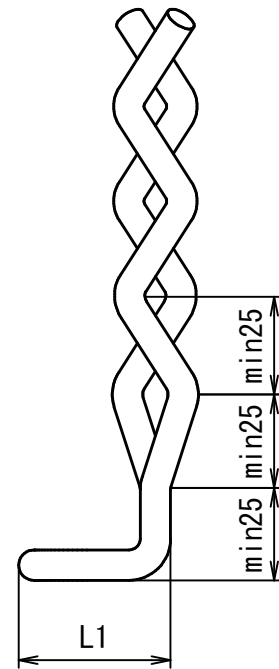
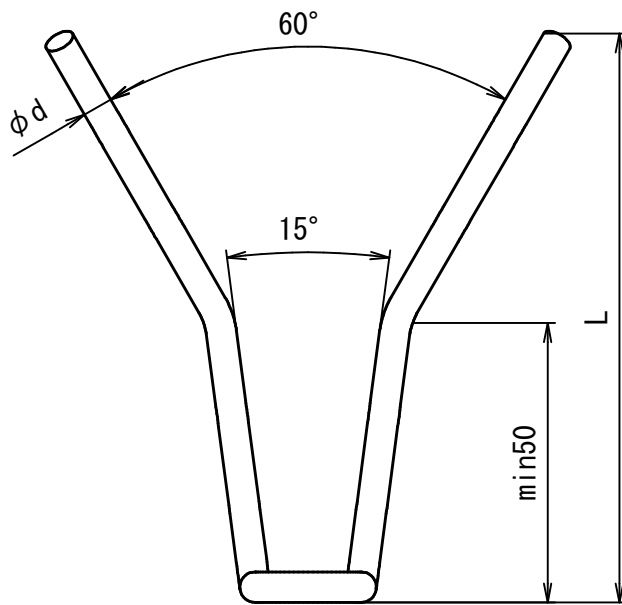
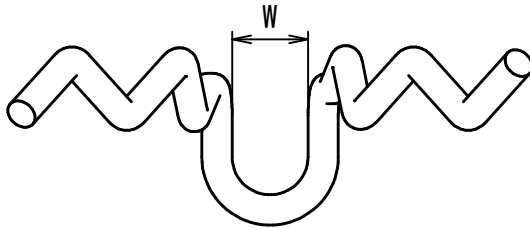
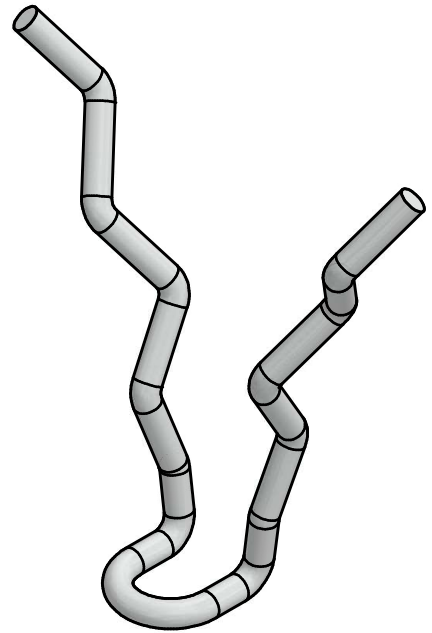

### Note

- The number of bends of the waves depends on the L dimension
- Options attached to the top CAPS or COATING

L1	min40	min40	min50	min50
W	10/13	10/20/25	25	25
$\phi d$	$\phi 6$	$\phi 8$	$\phi 9 / \phi 10$	$\phi 12$

Client		Item <b>60-VLCR-d-L</b>		
Delivery		DWG No.		Date 2020/06/01

	Appd. 西野	Drawn 中岡	Material	Qty.
--	-------------	-------------	----------	------



**Namitakiko Co.,Ltd.**



# VLPS Anchor

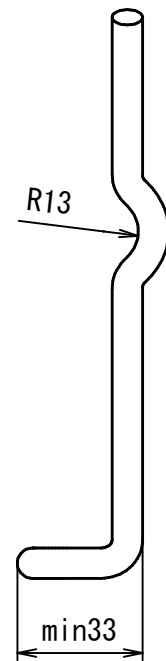
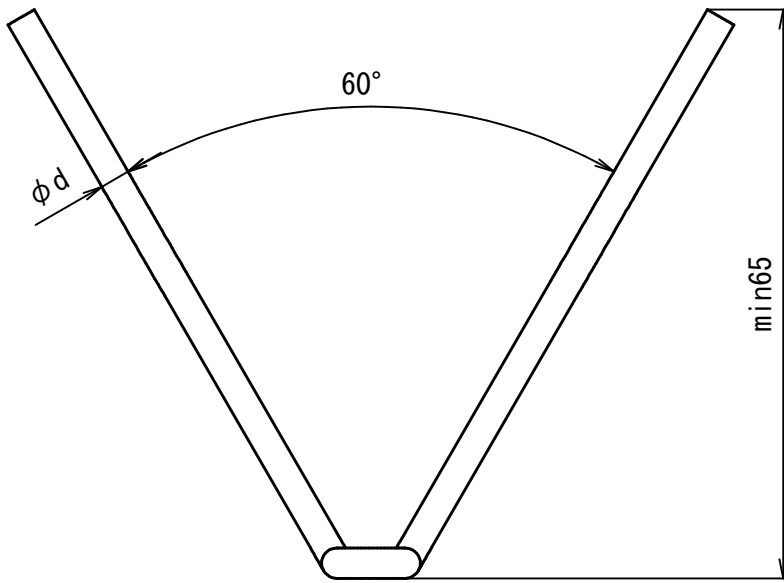
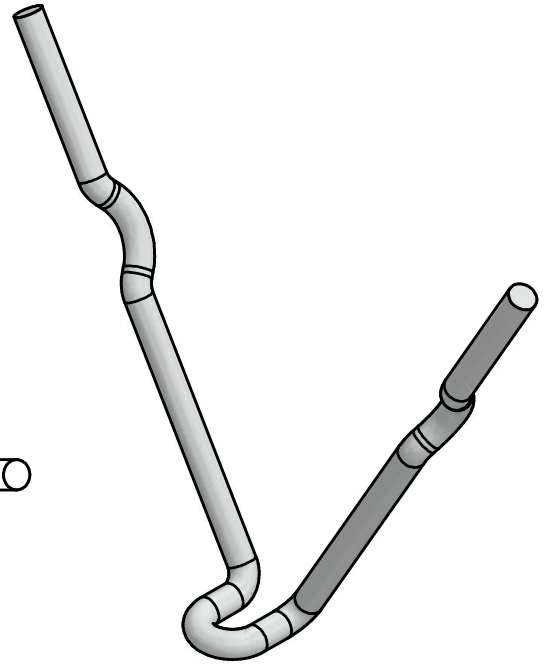
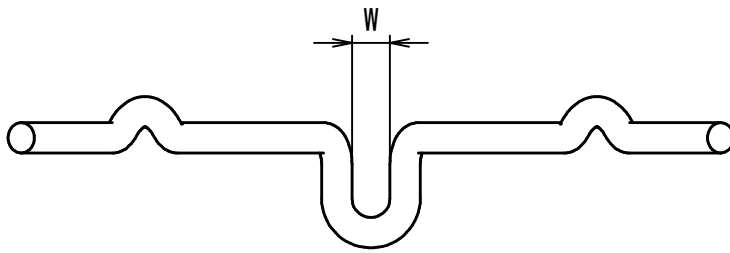

### Note

- The number of bends of the waves depends on the L dimension
- Options attached to the top CAPS or COATING

W	10/13	10/20/25	25	25
$\phi d$	$\phi 6$	$\phi 8$	$\phi 9/\phi 10$	$\phi 12$

Client	Item
	60-VLPS-d-L

Delivery	DWG No.	Date
		2020/06/01

	Appd. 西野	Drawn 中岡	Material	Qty.
--	-------------	-------------	----------	------



**Namitakiko Co.,Ltd.**



# VLPSW Anchor

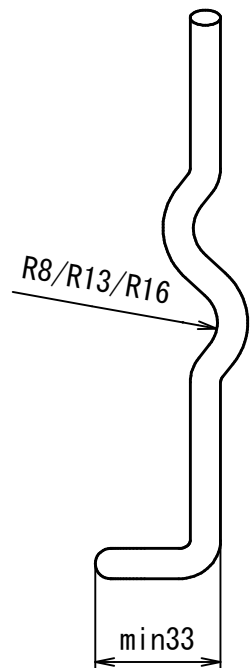
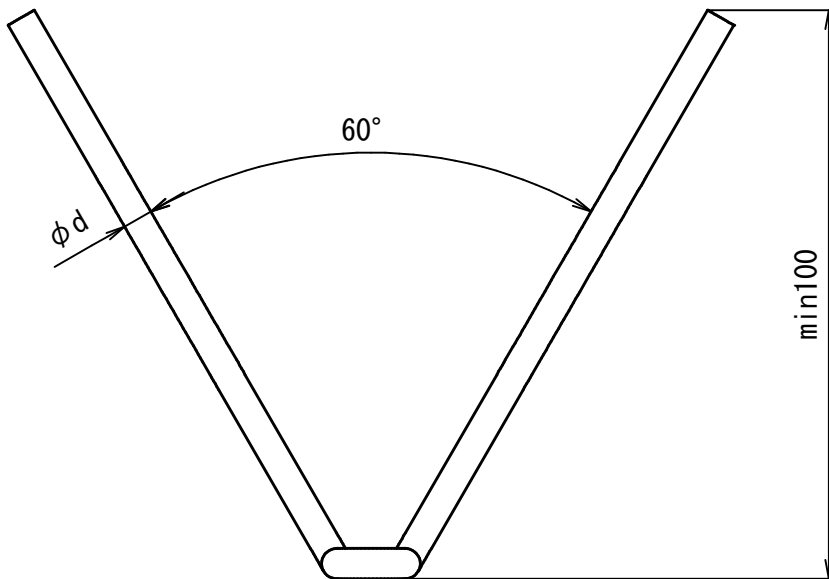
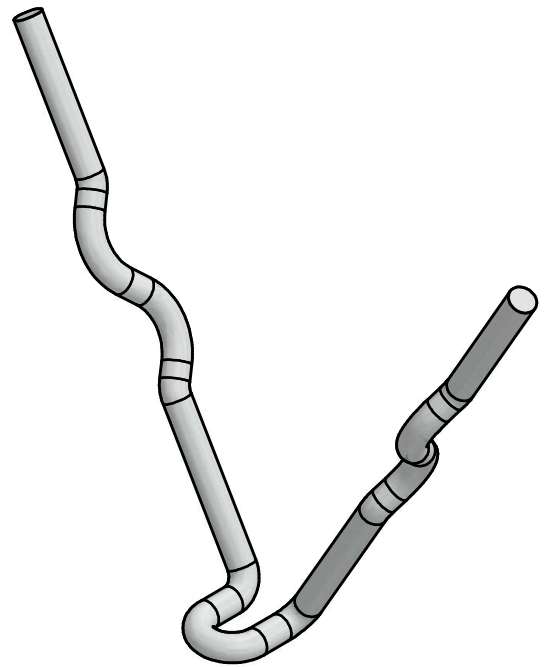
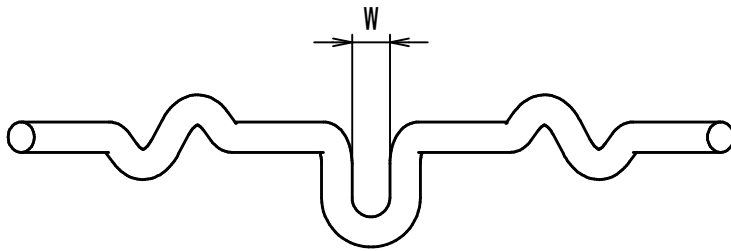

### Note

- The number of bends of the waves depends on the L dimension
- Options attached to the top CAPS or COATING

W	10/13	10/20/25	25	25
$\phi d$	$\phi 6$	$\phi 8$	$\phi 9/\phi 10$	$\phi 12$

Client

Item  
**60-VLPSW-d-L**

Delivery

DWG No.

Date  
2020/06/01

	Appd. 西野	Drawn 中岡	Material	Qty.
--	-------------	-------------	----------	------

**Namitakiko Co.,Ltd.**



# VLPR Anchor

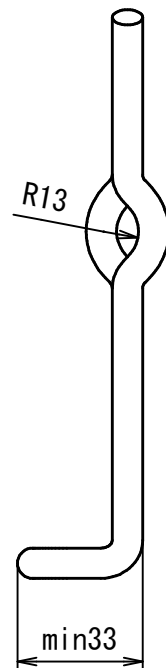
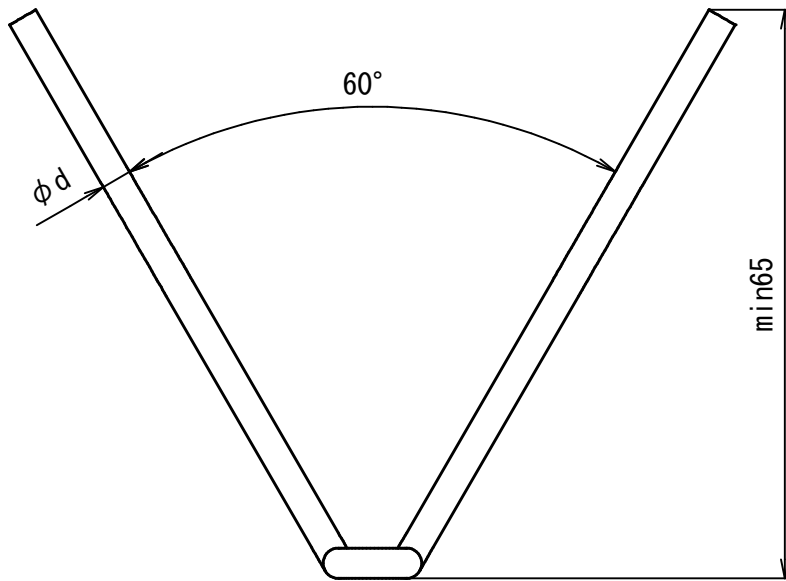
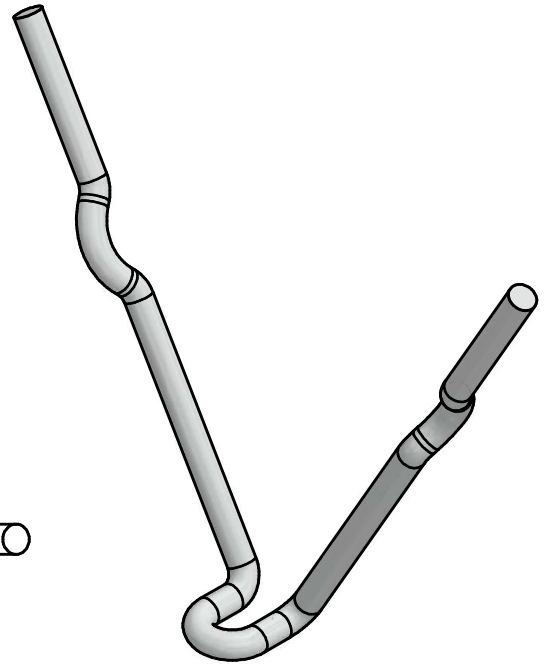
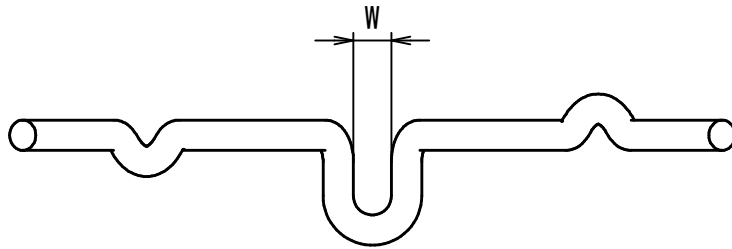

### Note

- The number of bends of the waves depends on the L dimension
- Options attached to the top CAPS or COATING

W	10/13	10/20/25	25	25
φd	φ6	φ8	φ9/φ10	φ12

Client

Item  
**60-VLPR-d-L**

Delivery

DWG No.

Date  
2020/06/01

	Appd. 西野	Drawn 中岡	Material	Qty.
--	-------------	-------------	----------	------

**Namitakiko Co.,Ltd.**



# VLPRW Anchor

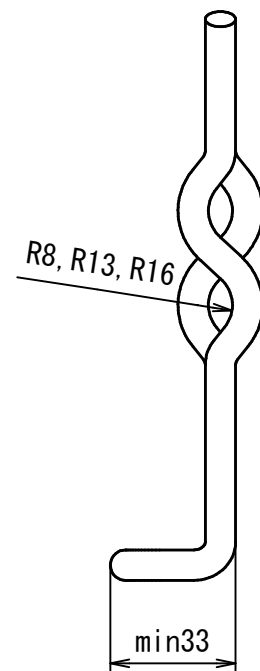
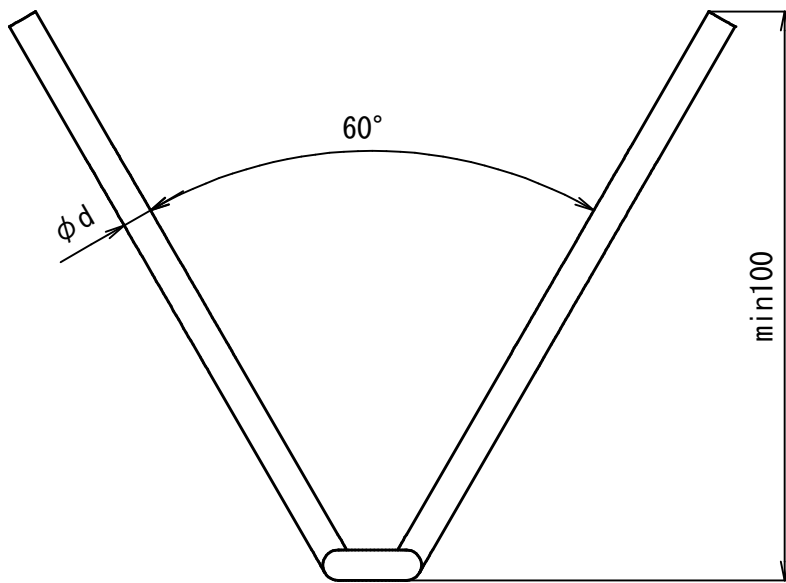
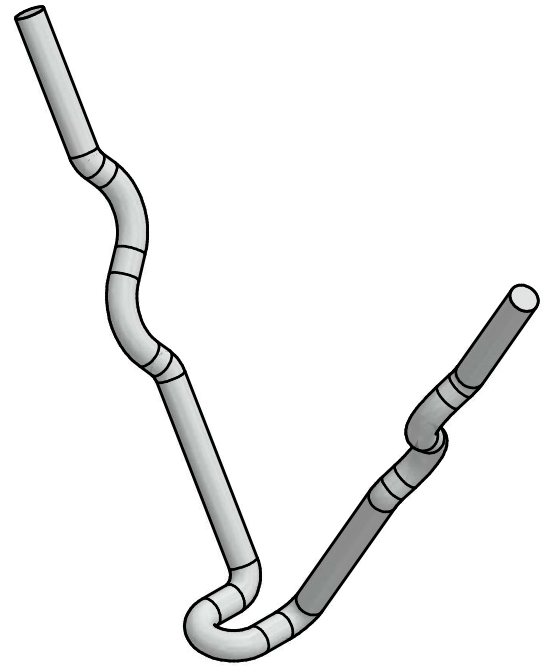
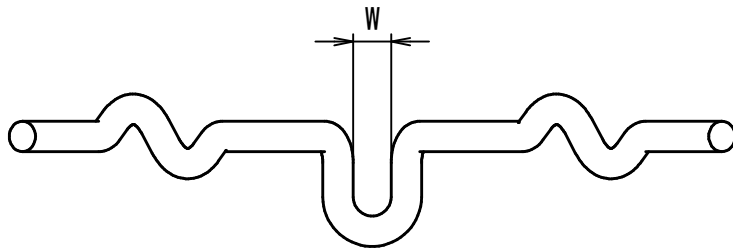

### Note

- The number of bends of the waves depends on the L dimension
- Options attached to the top CAPS or COATING

W	10/13	10/20/25	25	25
φd	φ6	φ8	φ9/φ10	φ12

Client

Item  
**60-VLPRW-d-L**

Delivery

DWG No.

Date  
2020/06/01

	Appd. 西野	Drawn 中岡	Material	Qty.
--	-------------	-------------	----------	------

**Namitakiko Co.,Ltd.**





# YB Anchor

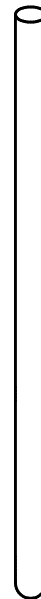
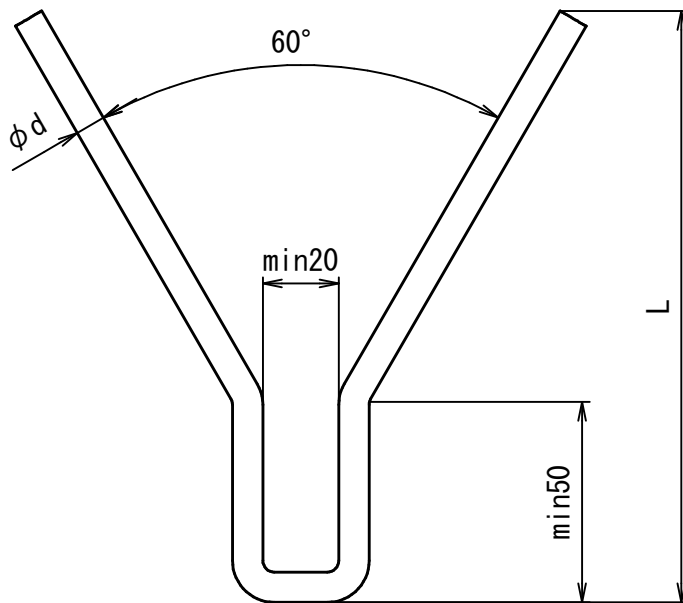
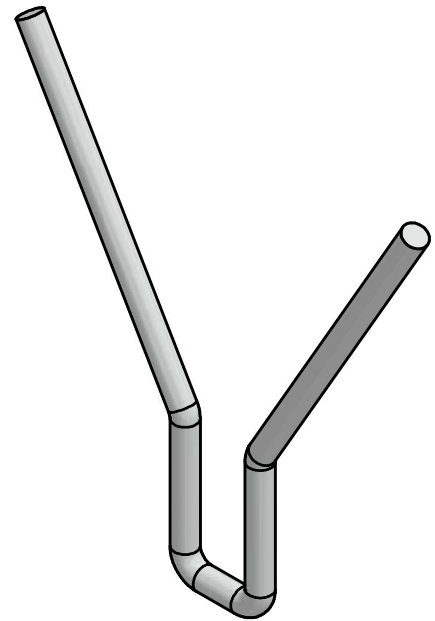
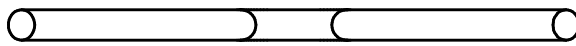

### Note

- The number of bends of the waves depends on the L dimension
- Options attached to the top CAPS or COATING

Client		Item		
		60-YB-d-L		
Delivery		DWG No.		Date
				2020/06/01
	Appd. 西野	Drawn 中岡	Material	Qty.
<b>Namitakiko Co.,Ltd.</b>				



# YB2 Anchor

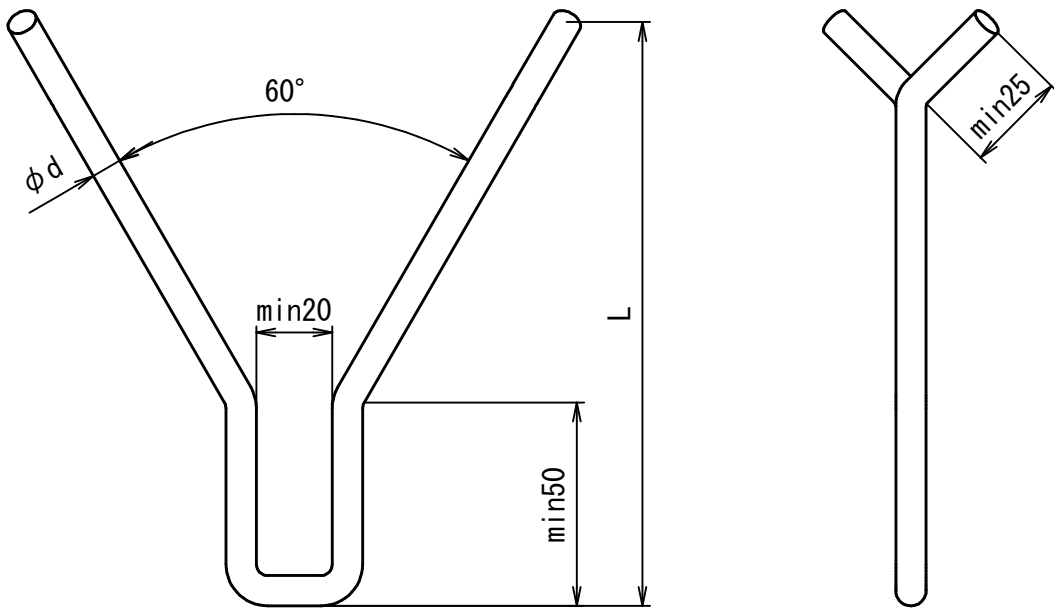
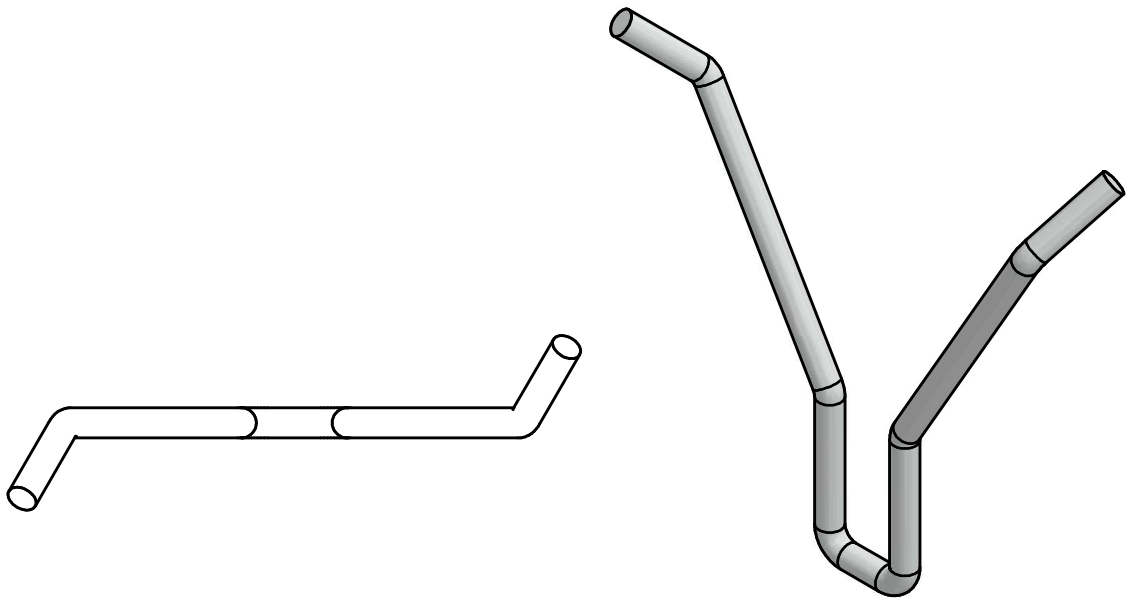

**Note**

- The number of bends of the waves depends on the L dimension
- Options attached to the top CAPS or COATING

Client		Item <b>60-YB2-d-L</b>		
Delivery		DWG No.		Date 2020/06/01
	Appd. 西野	Drawn 中岡	Material	Qty.
			<b>Namitakiko Co.,Ltd.</b>	



# YBS Anchor

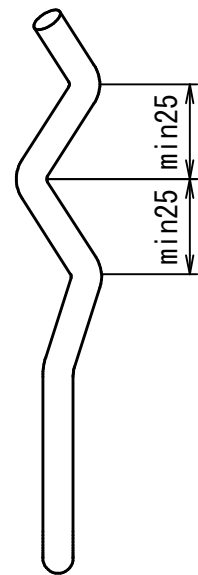
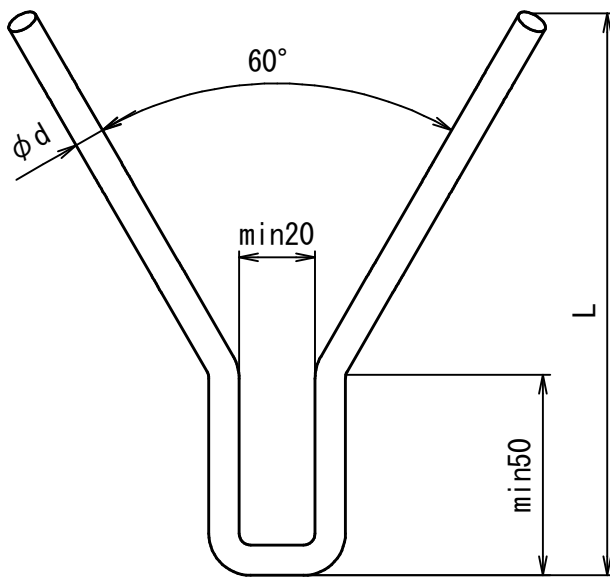
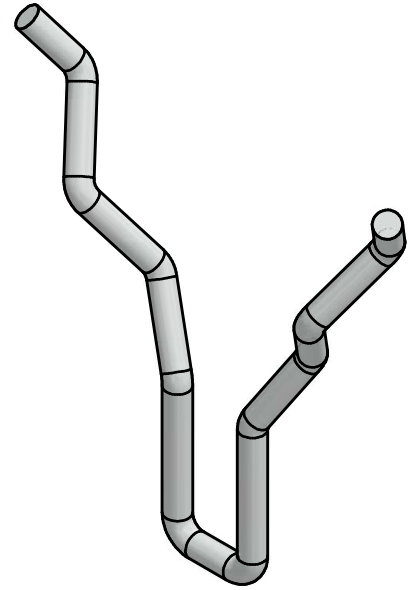
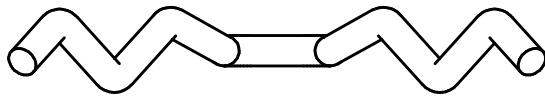

### Note

- The number of bends of the waves depends on the L dimension
- Options attached to the top CAPS or COATING

Client		Item <b>60-YBS-d-L</b>		
Delivery		DWG No.		Date 2020/06/01
	Appd. 西野	Drawn 中岡	Material	Qty.
		<b>Namitakiko Co.,Ltd.</b>		



# YBS1 Anchor

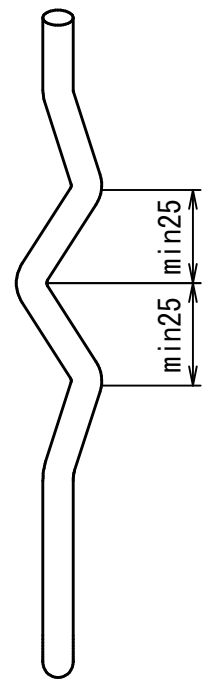
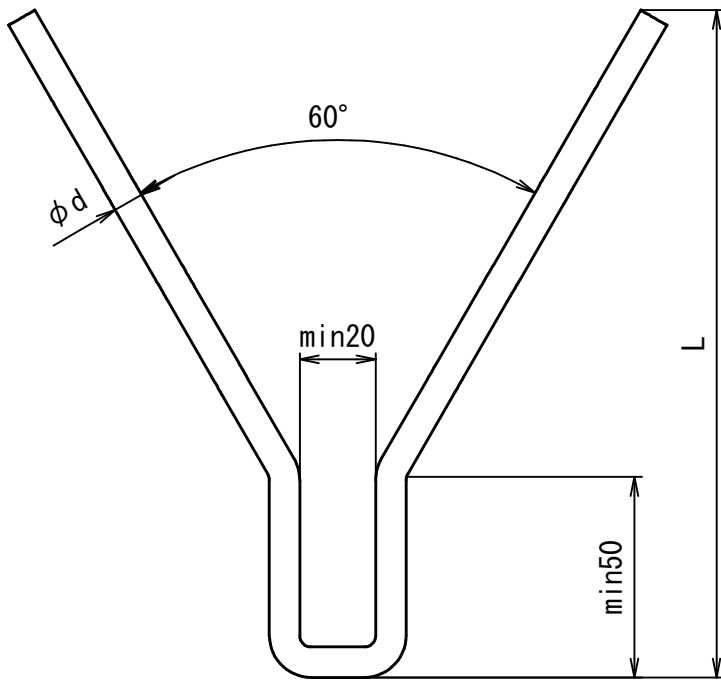
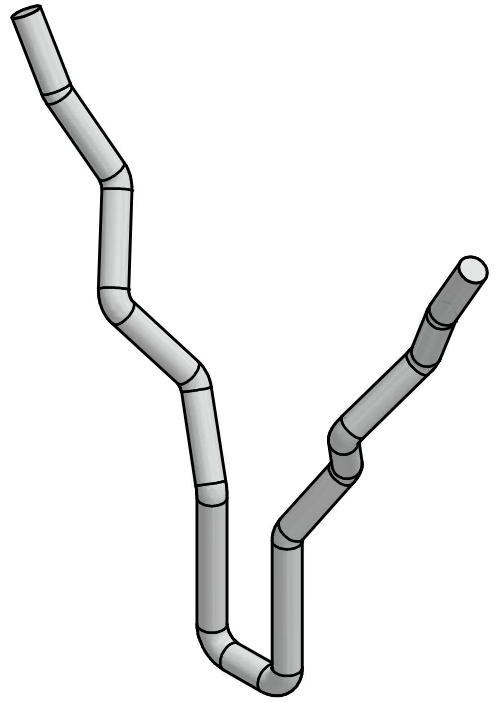
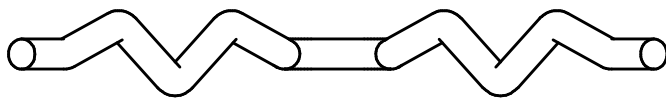

### Note

- The number of bends of the waves depends on the L dimension
- Options attached to the top CAPS or COATING

Client		Item	
		60-YBS1-d-L	
Delivery		DWG No.	Date
			2020/06/01
	Appd. 西野	Drawn 中岡	Material Qty.
		<b>Namitakiko Co.,Ltd.</b>	



# YBR Anchor

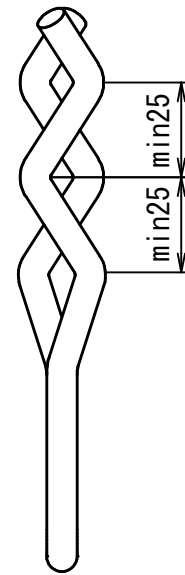
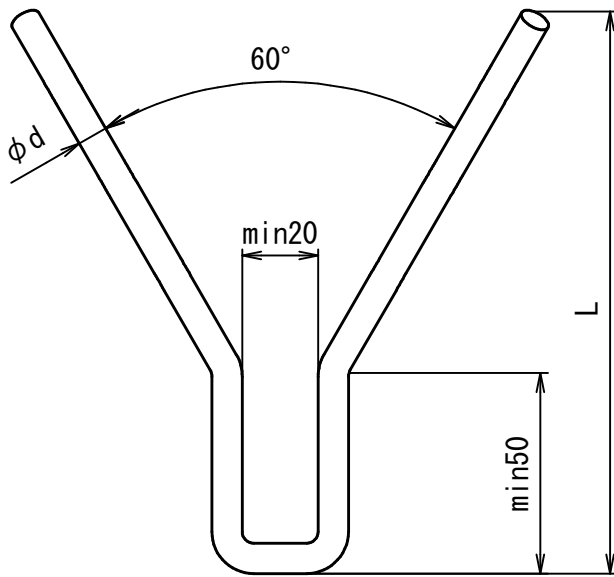
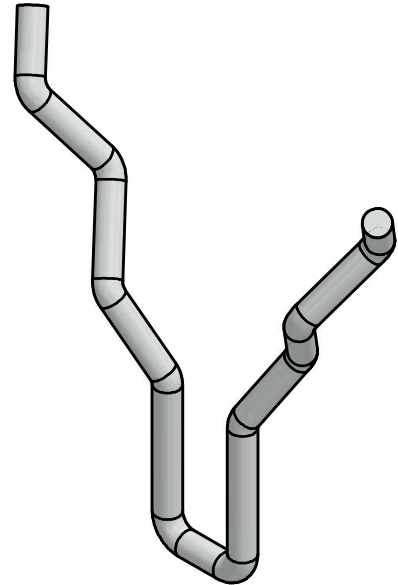
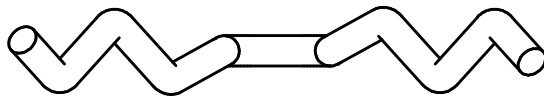

### Note

- The number of bends of the waves depends on the L dimension
- Options attached to the top CAPS or COATING

Client		Item 60-YBR-d-L		
Delivery		DWG No.		Date 2020/06/01
	Appd. 西野	Drawn 中岡	Material	Qty.
			<b>Namitakiko Co.,Ltd.</b>	



# YBR1 Anchor

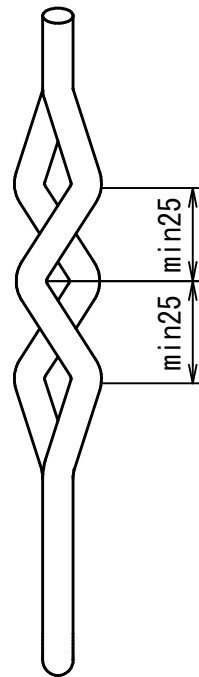
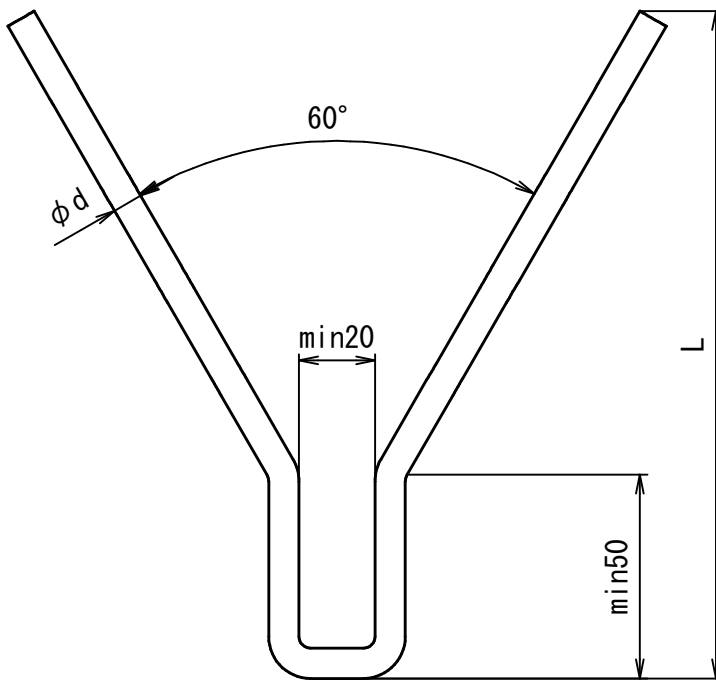
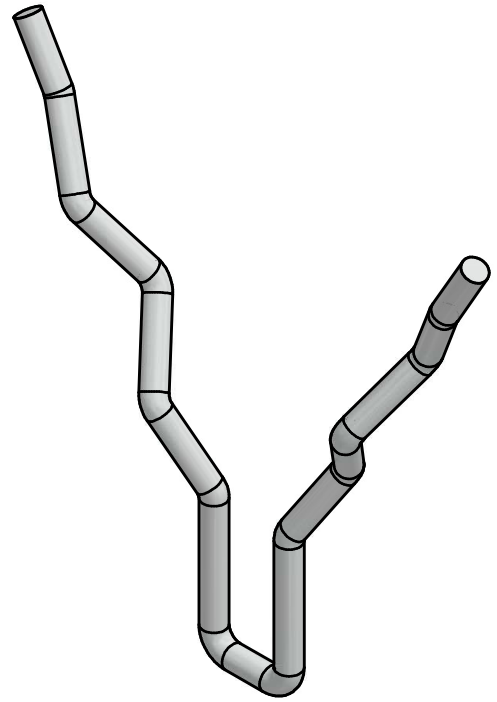
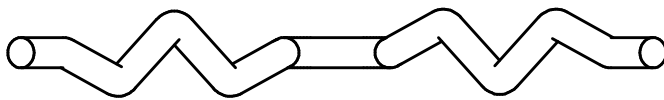

## Note

- The number of bends of the waves depends on the L dimension
- Options attached to the top CAPS or COATING

Client		Item <b>60-YBR1-d-L</b>		
Delivery		DWG No.		Date 2020/06/01
	Appd. 西野	Drawn 中岡	Material	Qty.
		<b>Namitakiko Co.,Ltd.</b>		



# YBF Anchor

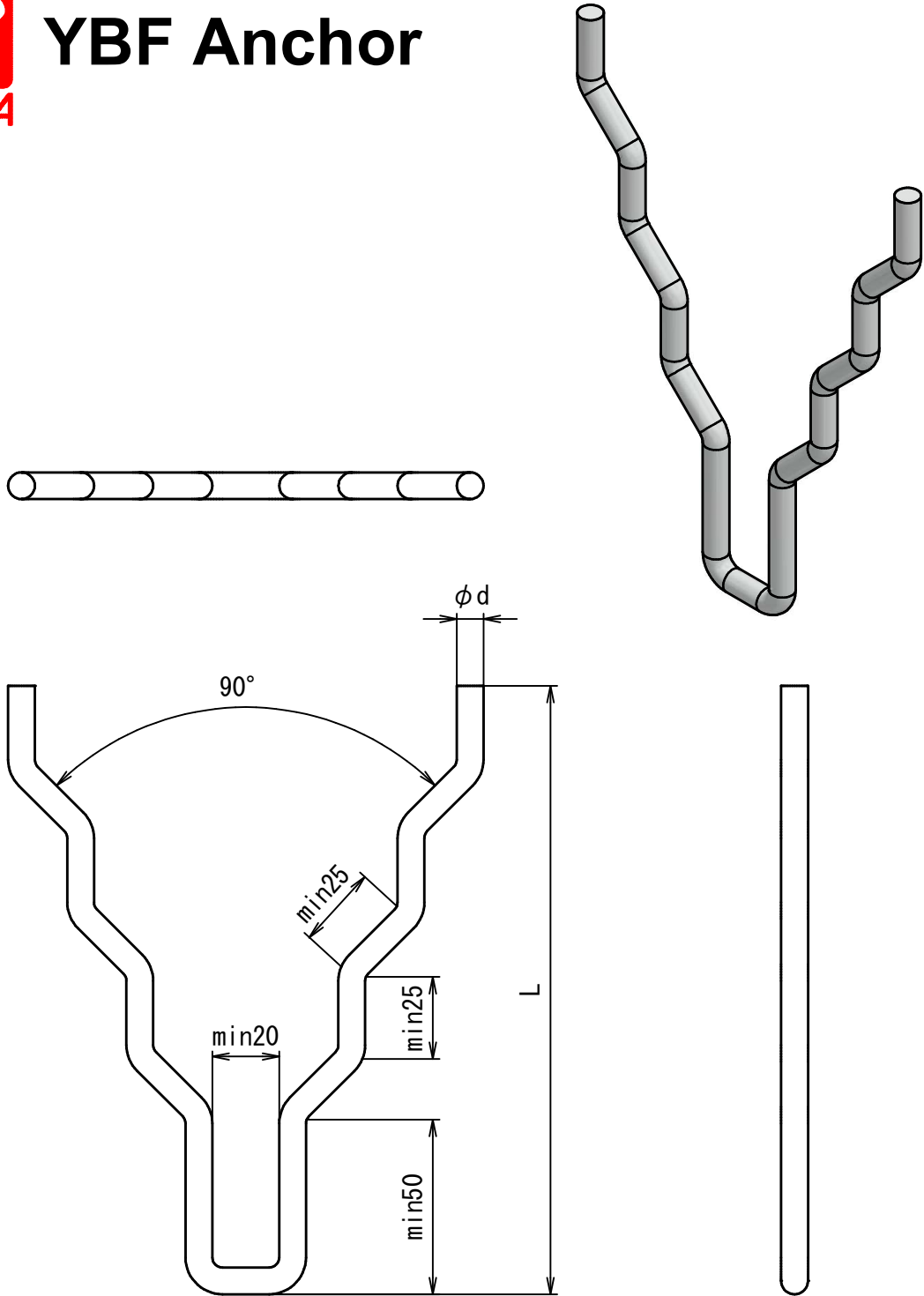

### Note

- The number of bends of the waves depends on the L dimension
- Options attached to the top CAPS or COATING

Client				Item 60-YBF-d-L	
Delivery				DWG No.	
				Date 2020/06/01	
	Appd. 西野	Drawn 中岡	Material	Qty.	<b>Namitakiko Co.,Ltd.</b>



# YL Anchor

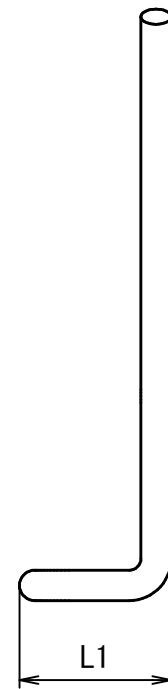
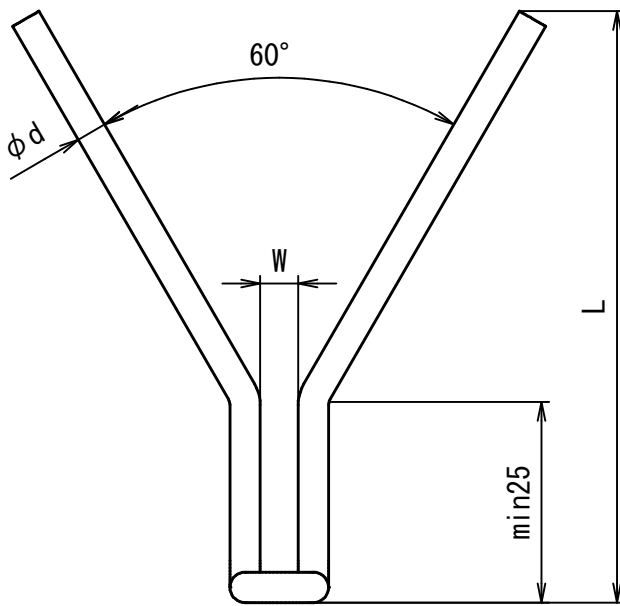
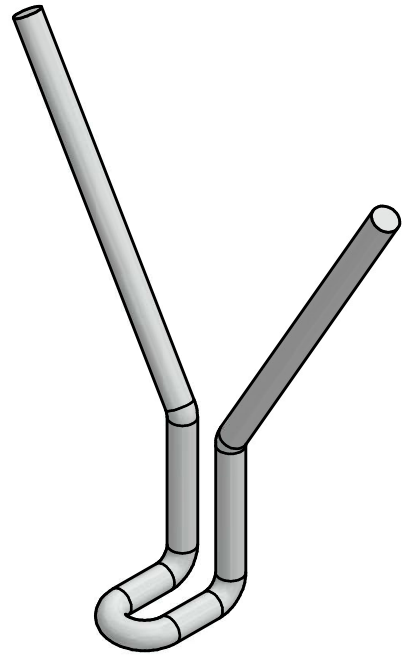
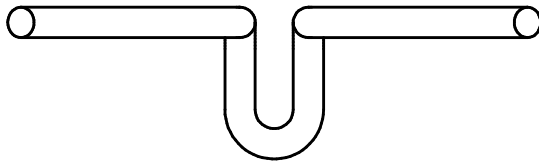

### Note

- The number of bends of the waves depends on the L dimension
- Options attached to the top CAPS or COATING

L1	min40	min40	min50	min50
W	10/13	10/20/25	25	25
$\phi d$	$\phi 6$	$\phi 8$	$\phi 9 / \phi 10$	$\phi 12$

Client		Item <b>60-YL-d-L</b>		
Delivery		DWG No.		Date 2020/06/01

	Appd. 西野	Drawn 中岡	Material	Qty.
--	-------------	-------------	----------	------



**Namitakiko Co.,Ltd.**





# YL2 Anchor

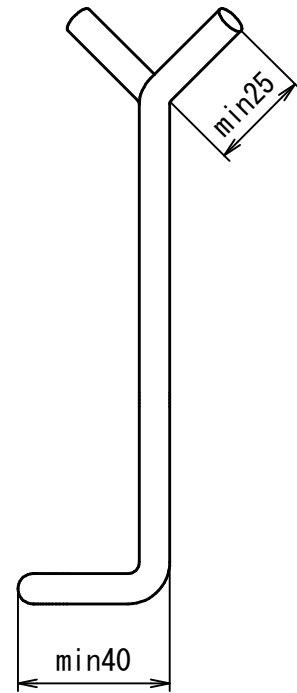
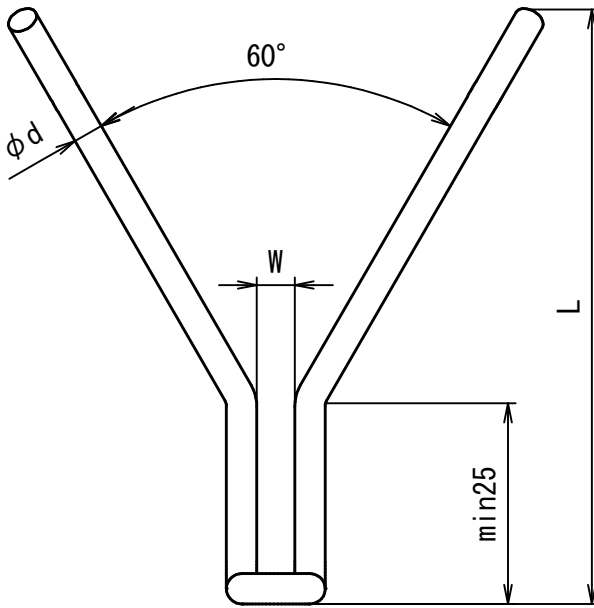
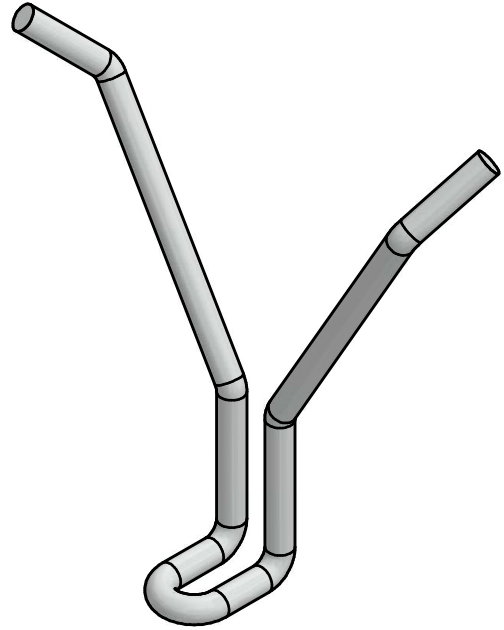
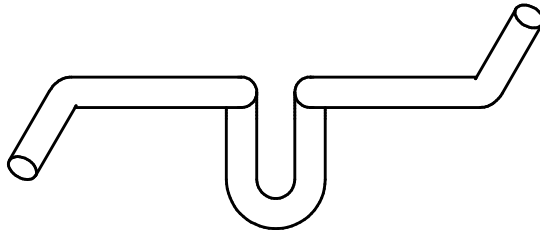

**Note**

- The number of bends of the waves depends on the L dimension
- Options attached to the top CAPS or COATING

L1	min40	min40	min50	min50
W	10/13	10/20/25	25	25
$\phi d$	$\phi 6$	$\phi 8$	$\phi 9 / \phi 10$	$\phi 12$

Client		Item <b>60-YL2-d-L</b>		
Delivery		DWG No.		Date 2020/06/01

	Appd. 西野	Drawn 中岡	Material	Qty.
--	-------------	-------------	----------	------



# YLS Anchor

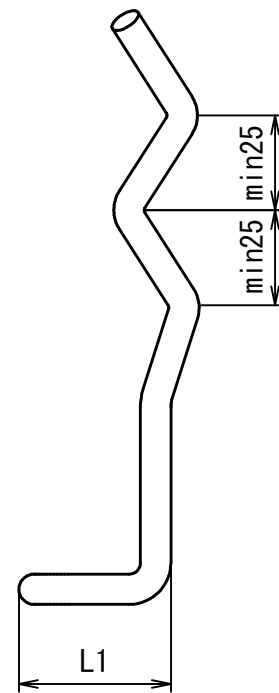
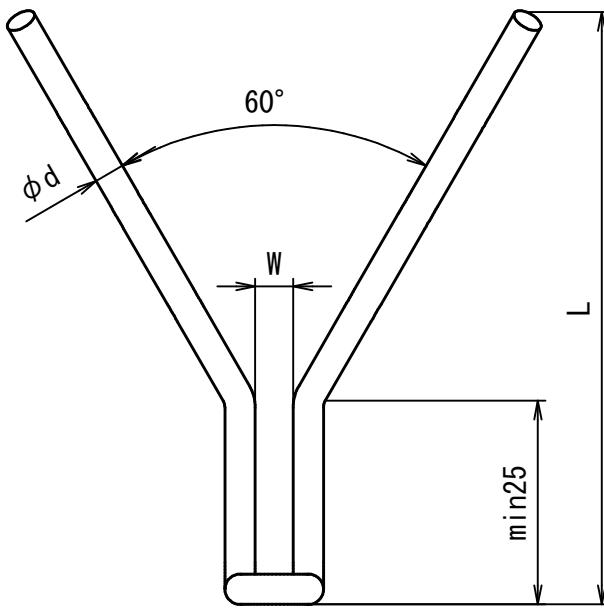
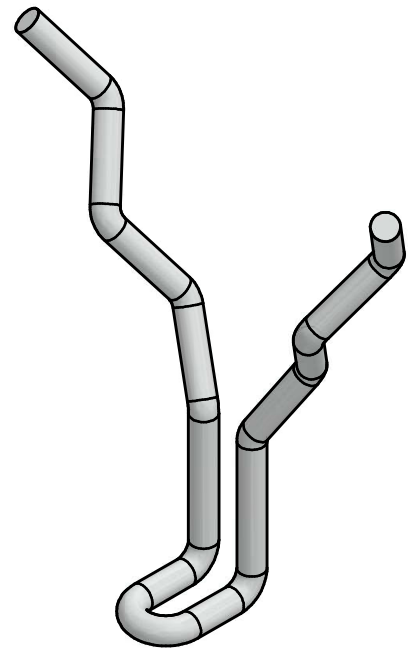
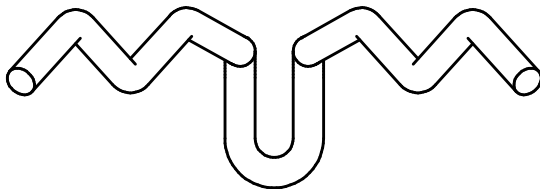

### Note

- The number of bends of the waves depends on the L dimension
- Options attached to the top CAPS or COATING

L1	min40	min40	min50	min50
W	10/13	10/20/25	25	25
$\phi d$	$\phi 6$	$\phi 8$	$\phi 9 / \phi 10$	$\phi 12$

Client			Item <b>60-YLS-d-L</b>	
Delivery			DWG No.	Date 2020/06/01
	Appd. 西野	Drawn 中岡	Material	Qty.
			<b>Namitakiko Co.,Ltd.</b>	



# YLS1 Anchor

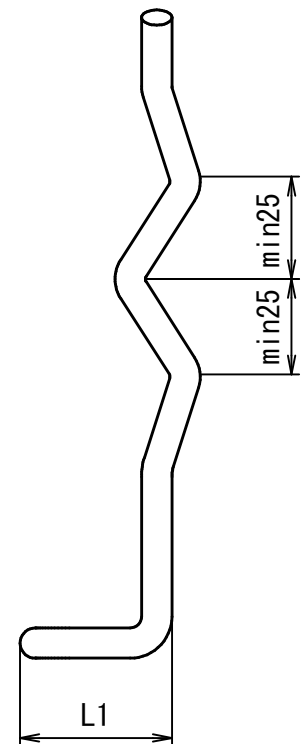
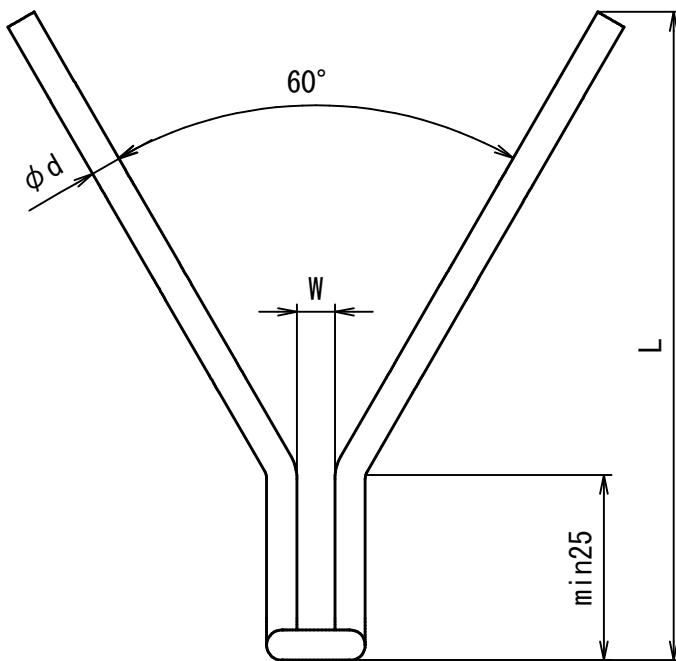
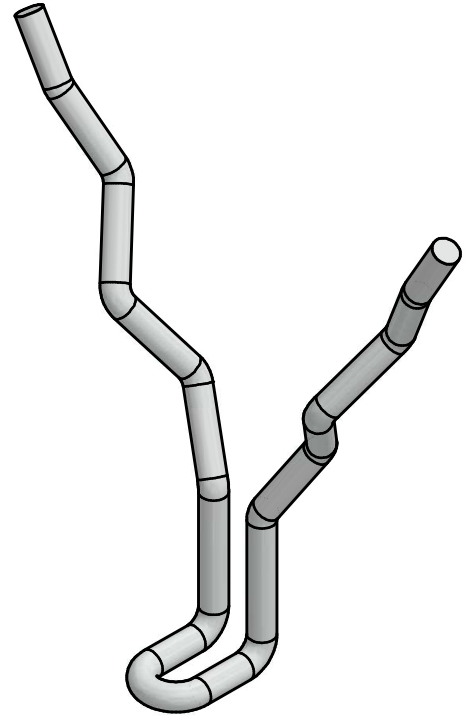
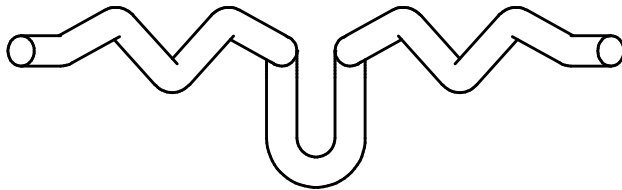

### Note

- The number of bends of the waves depends on the L dimension
- Options attached to the top CAPS or COATING

L1	min40	min40	min50	min50
W	10/13	10/20/25	25	25
$\phi d$	$\phi 6$	$\phi 8$	$\phi 9 / \phi 10$	$\phi 12$

Client		Item <b>60-YLS1-d-L</b>		
Delivery		DWG No.		Date 2020/06/01

	Appd. 西野	Drawn 中岡	Material	Qty.
--	-------------	-------------	----------	------



**Namitakiko Co.,Ltd.**



# YLR Anchor

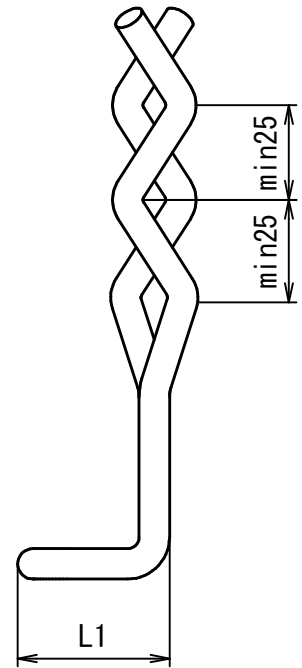
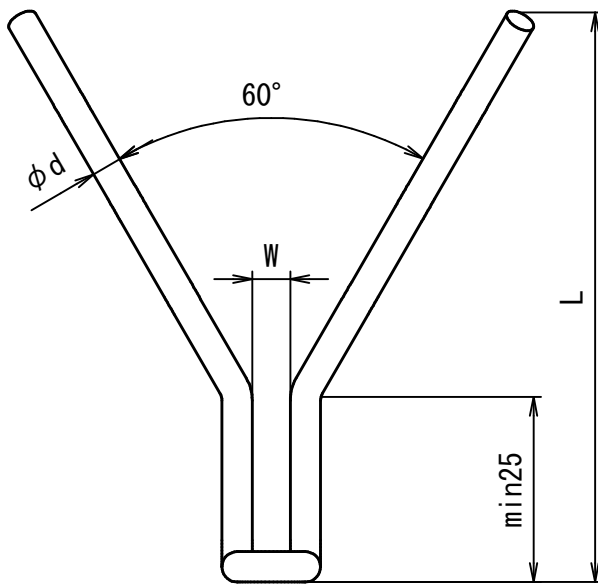
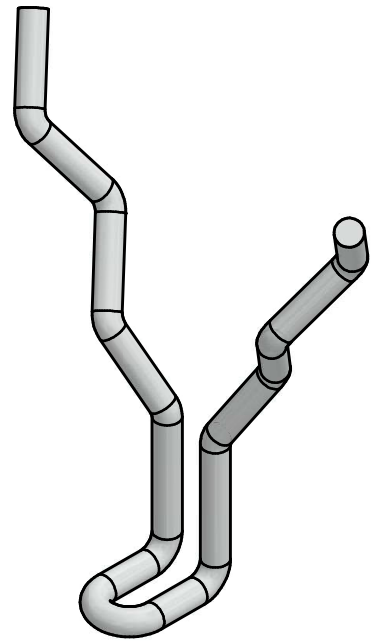
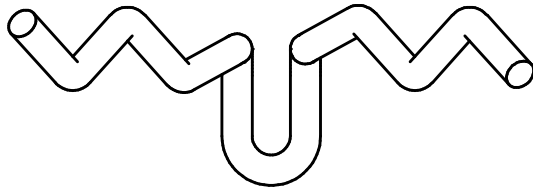

### Note

- The number of bends of the waves depends on the L dimension
- Options attached to the top CAPS or COATING

L1	min40	min40	min50	min50
W	10/13	10/20/25	25	25
$\phi d$	$\phi 6$	$\phi 8$	$\phi 9 / \phi 10$	$\phi 12$

Client		Item <b>60-YLR-d-L</b>		
Delivery		DWG No.		Date 2020/06/01

	Appd. 西野	Drawn 中岡	Material	Qty.
--	-------------	-------------	----------	------



**Namitakiko Co.,Ltd.**



# YLR1 Anchor

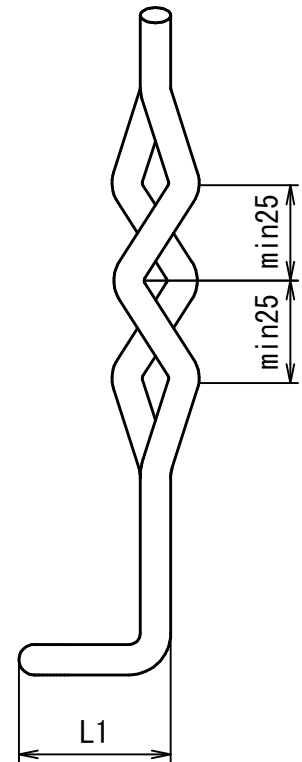
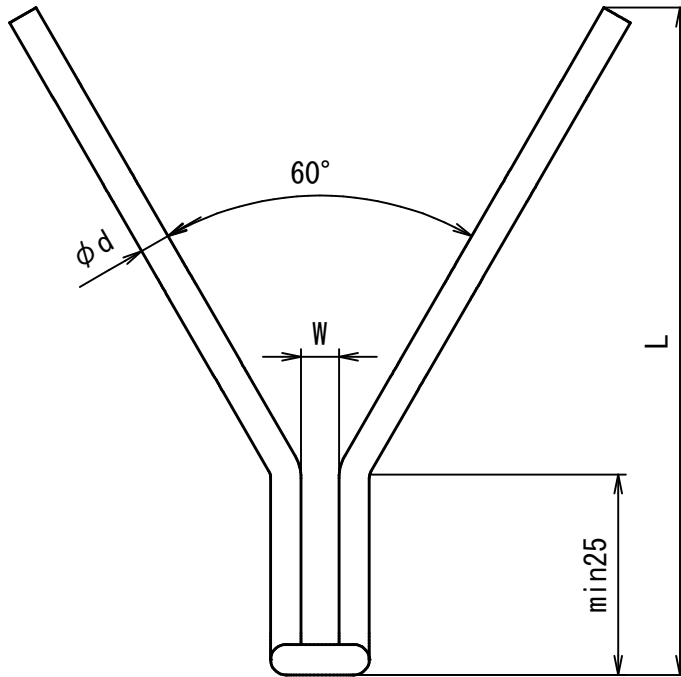
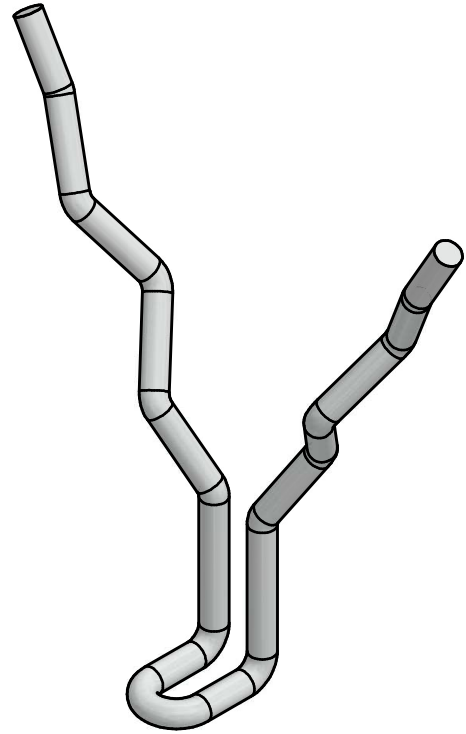
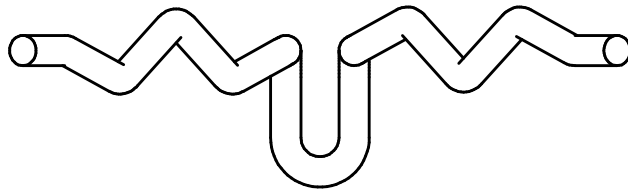

### Note

- The number of bends of the waves depends on the L dimension
- Options attached to the top CAPS or COATING

L1	min40	min40	min50	min50
W	10/13	10/20/25	25	25
ϕd	ϕ6	ϕ8	ϕ9/ϕ10	ϕ12

Client		Item <b>60-YLR1-d-L</b>		
Delivery		DWG No.		Date 2020/06/01

	Appd. 西野	Drawn 中岡	Material	Qty.
--	-------------	-------------	----------	------



**Namitakiko Co.,Ltd.**



# YLF Anchor

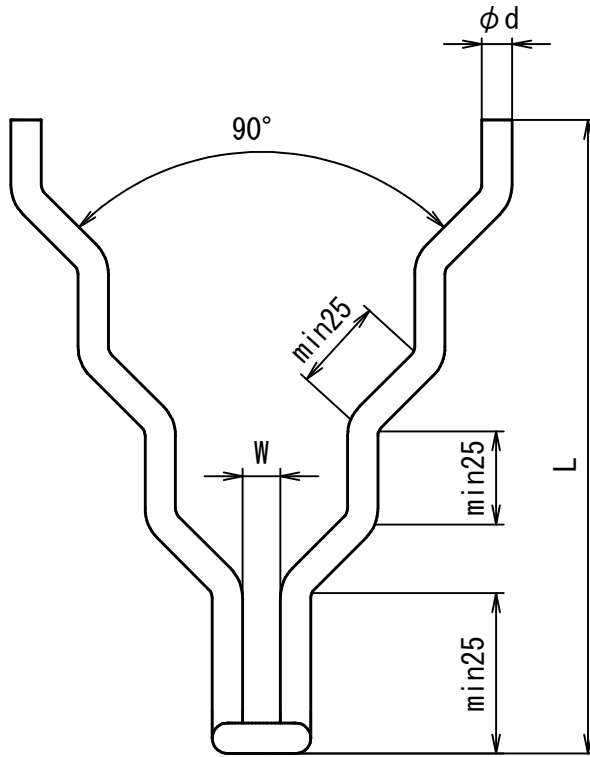
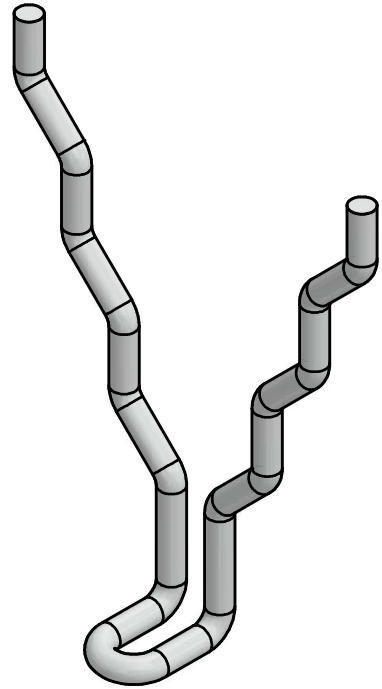
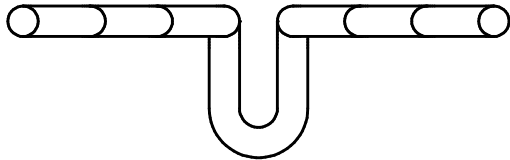

**Note**

- The number of bends of the waves depends on the L dimension
- Options attached to the top CAPS or COATING

L1	min40	min40	min50	min50
W	10/13	10/20/25	25	25
φ d	φ 6	φ 8	φ 9/φ 10	φ 12

Client		Item <b>60-YLF-d-L</b>		
Delivery		DWG No.		Date 2020/06/01

	Appd. 西野	Drawn 中岡	Material	Qty.
--	-------------	-------------	----------	------



# YLPS Anchor

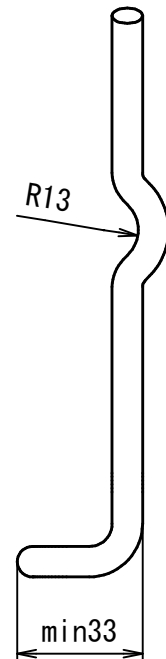
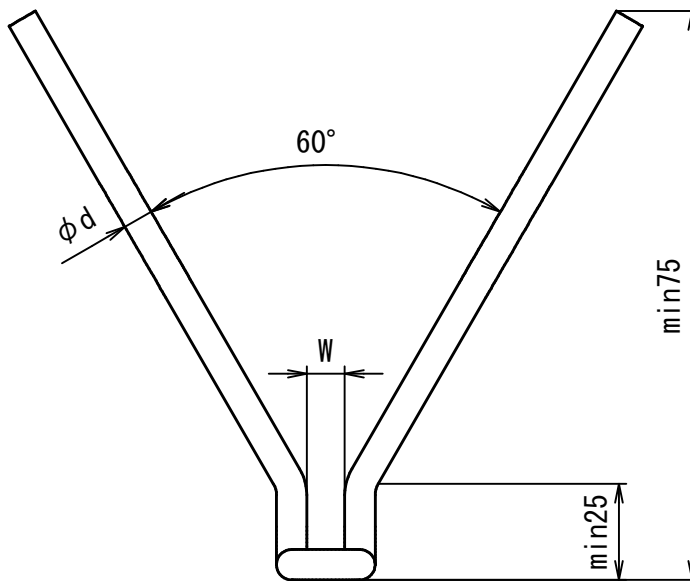
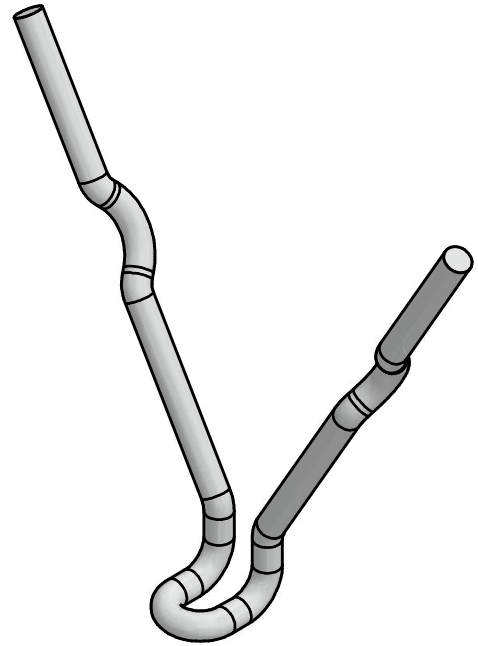
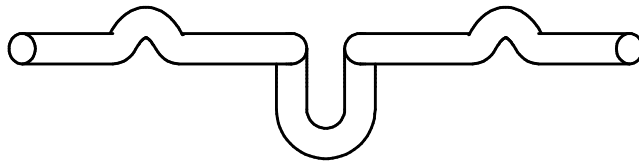

**Note**

- The number of bends of the waves depends on the L dimension
- Options attached to the top CAPS or COATING

W	10/13	10/20/25	25	25
φd	φ6	φ8	φ9/φ10	φ12

Client		Item <b>60-YLPS-d-L</b>		
Delivery		DWG No.	Date 2020/06/01	

	Appd. 西野	Drawn 中岡	Material	Qty.
--	-------------	-------------	----------	------



**Namitakiko Co.,Ltd.**



# YLPSW Anchor

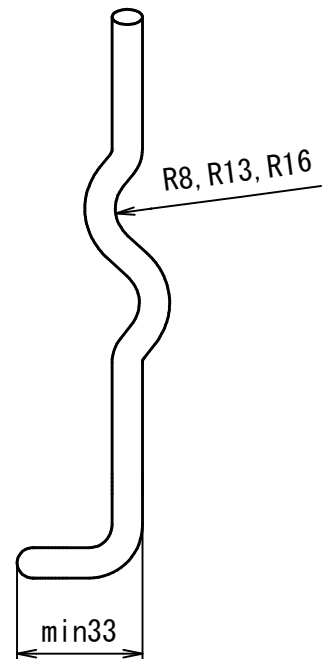
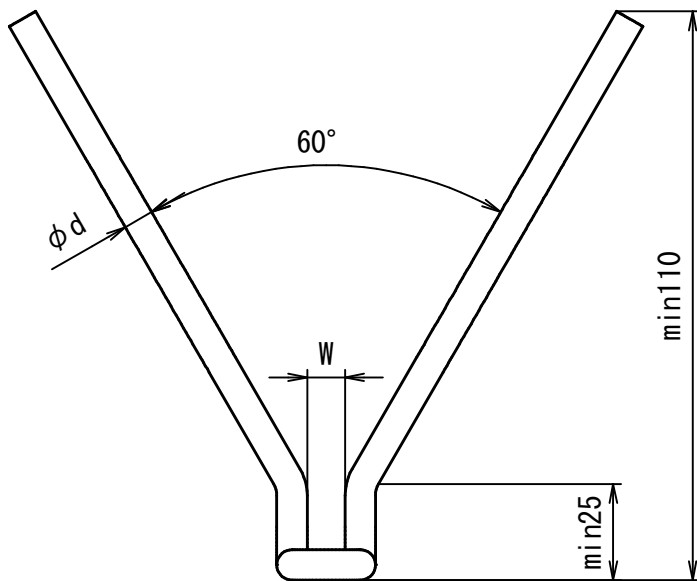
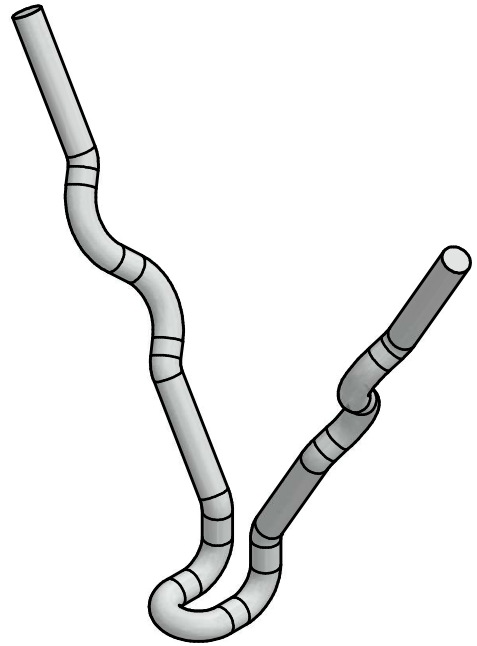
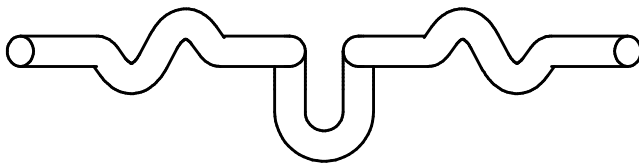

### Note

- The number of bends of the waves depends on the L dimension
- Options attached to the top CAPS or COATING

W	10/13	10/20/25	25	25
$\phi d$	$\phi 6$	$\phi 8$	$\phi 9/\phi 10$	$\phi 12$

Client	Item			
	60-YLPSW-d-L			

Delivery	DWG No.		Date	
			2020/06/01	

	Appd. 西野	Drawn 中岡	Material	Qty.
--	-------------	-------------	----------	------



**Namitakiko Co.,Ltd.**





# YLPR Anchor

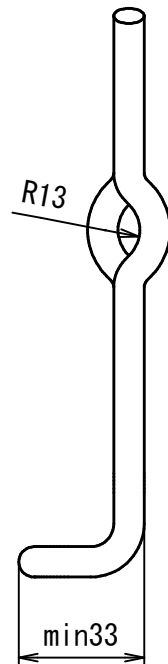
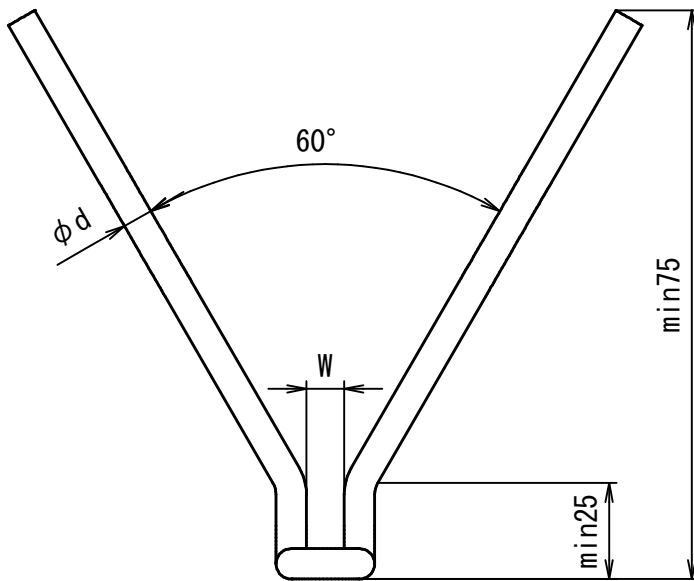
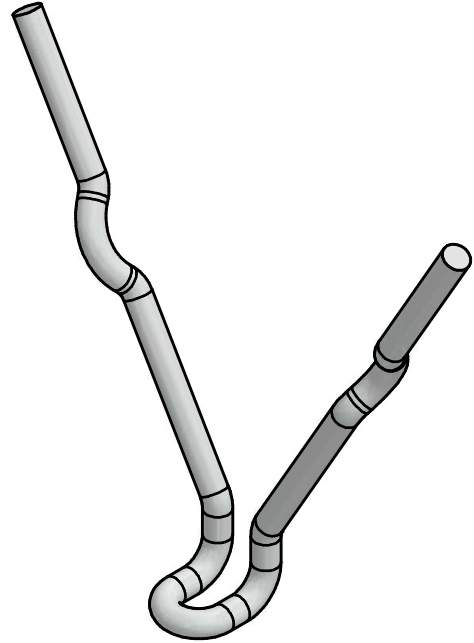
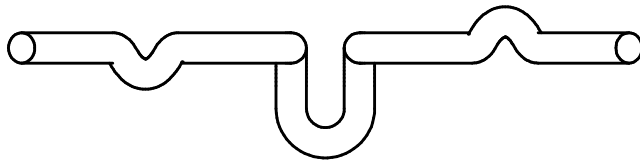

### Note

- The number of bends of the waves depends on the L dimension
- Options attached to the top CAPS or COATING

W	10/13	10/20/25	25	25
$\phi d$	$\phi 6$	$\phi 8$	$\phi 9/\phi 10$	$\phi 12$

Client		Item	
		60-YLPR-d-L	
Delivery		DWG No.	Date
			2020/06/01

	Appd. 西野	Drawn 中岡	Material	Qty.
--	-------------	-------------	----------	------



**Namitakiko Co.,Ltd.**



# YLPRW Anchor

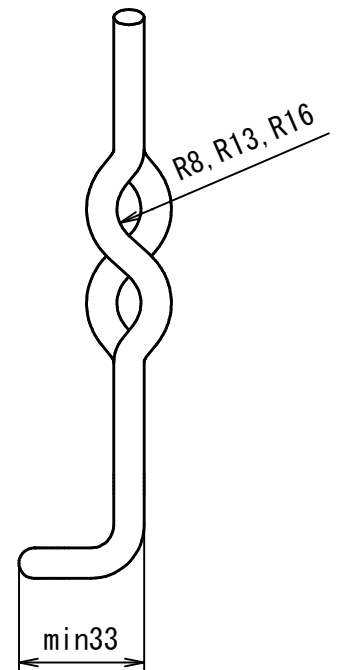
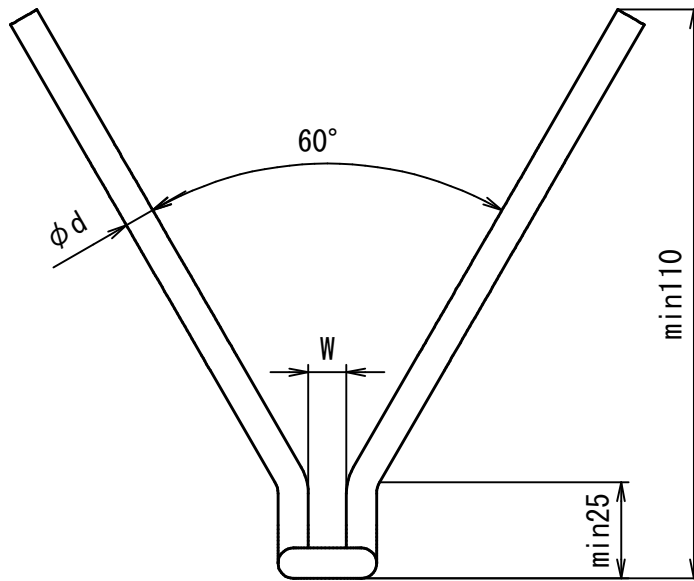
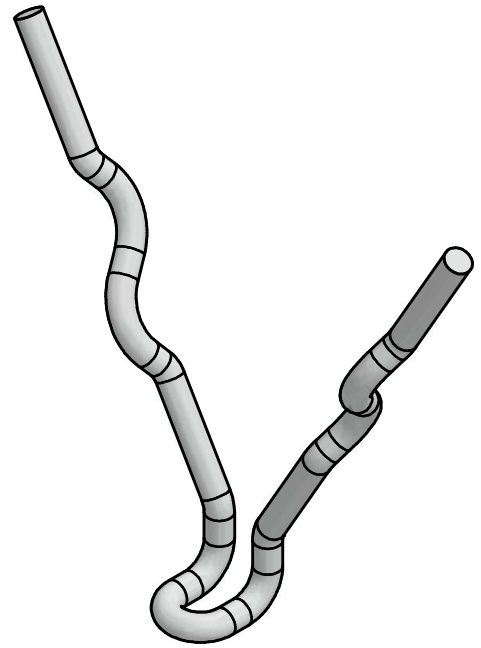
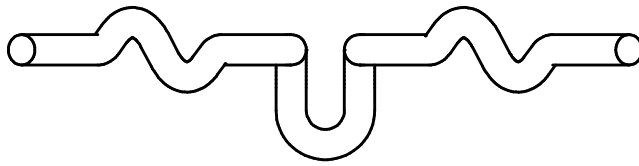

### Note

- The number of bends of the waves depends on the L dimension
- Options attached to the top CAPS or COATING

W	10/13	10/20/25	25	25
$\phi d$	$\phi 6$	$\phi 8$	$\phi 9/\phi 10$	$\phi 12$

Client

Item  
**60-YLPRW-d-L**

Delivery

DWG No.  
Date  
2020/06/01

	Appd. 西野	Drawn 中岡	Material	Qty.
--	-------------	-------------	----------	------

**Namitakiko Co.,Ltd.**



# YT Anchor

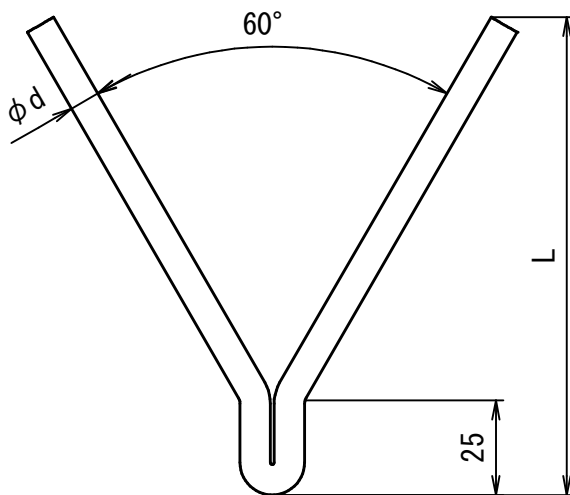
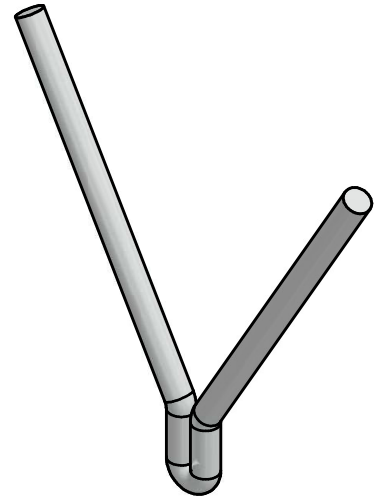

### Note

- The number of bends of the waves depends on the L dimension
- Options attached to the top CAPS or COATING

Client		Item		
		60-YT-d-L		
Delivery		DWG No.		Date
				2020/06/01
	Appd. 西野	Drawn 中岡	Material	Qty.
<b>Namitakiko Co.,Ltd.</b>				



# YLT Anchor

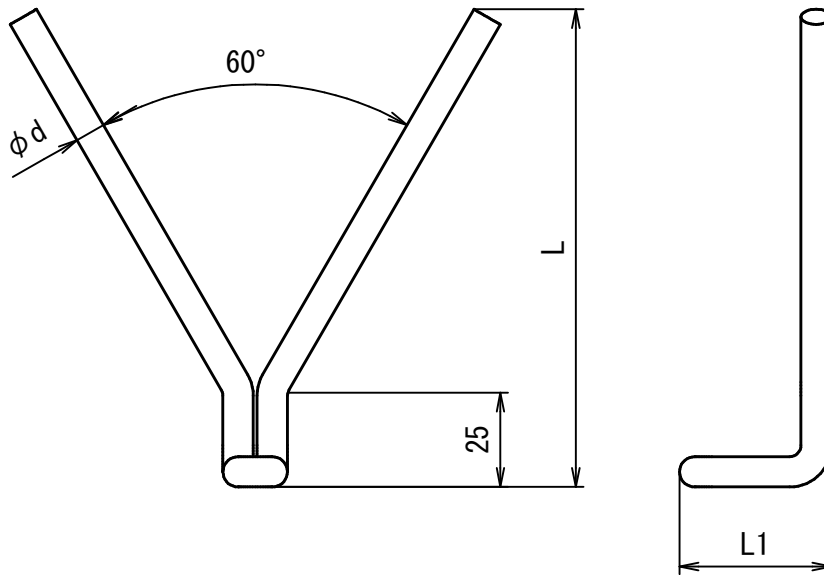
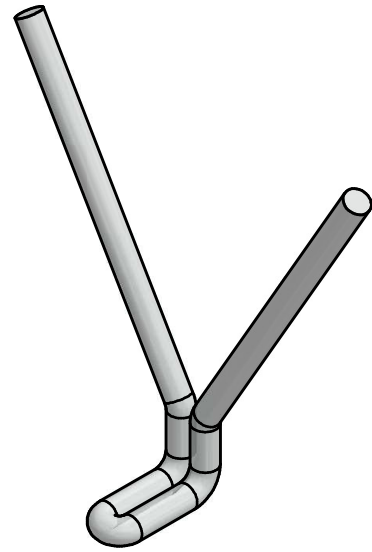
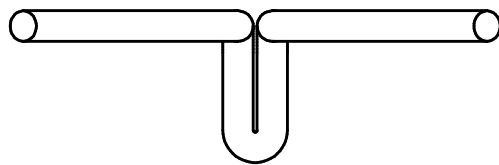

**Note**

- The number of bends of the waves depends on the L dimension
- Options attached to the top CAPS or COATING

Client		Item <b>60-YLT-d-L</b>		
Delivery		DWG No.		Date 2020/06/01
	Appd. 西野	Drawn 中岡	Material	Qty.
			<b>Namitakiko Co.,Ltd.</b>	



# YTS Anchor

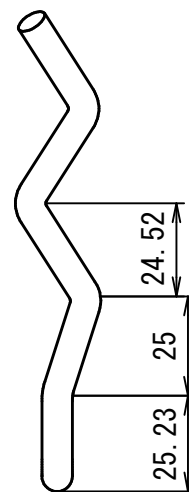
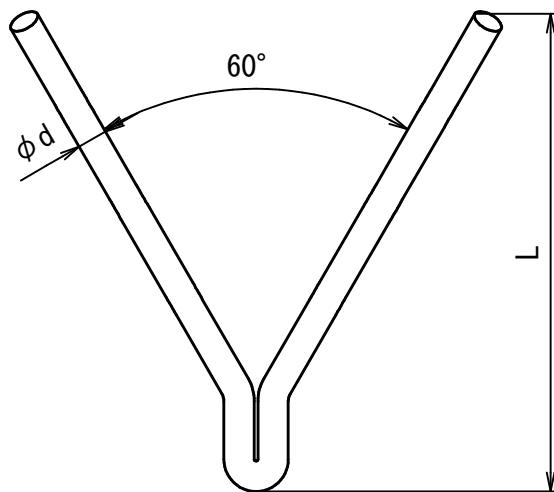
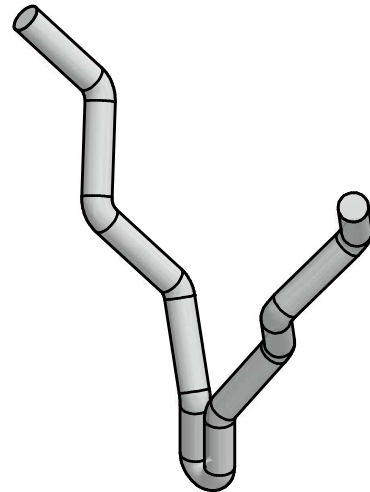
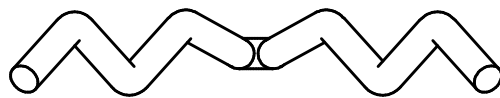

### Note

- The number of bends of the waves depends on the L dimension
- Options attached to the top CAPS or COATING

Client		Item <b>60-YTS-d-L</b>		
Delivery		DWG No.		Date 2020/06/01
	Appd. 西野	Drawn 中岡	Material	Qty.
			<b>Namitakiko Co.,Ltd.</b>	



# YTR Anchor

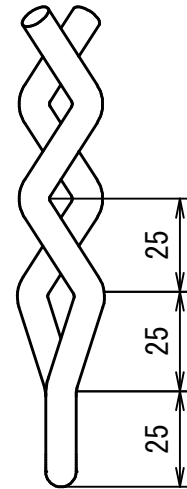
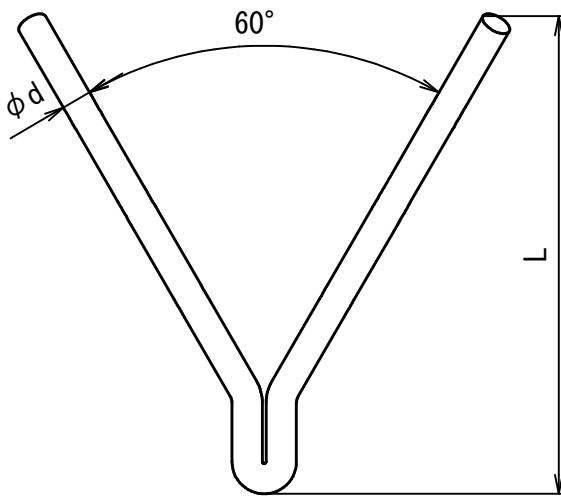
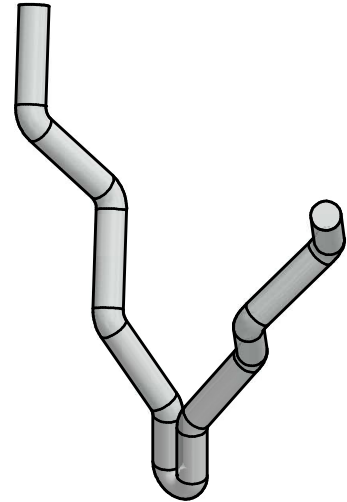
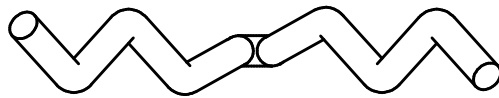

### Note

- The number of bends of the waves depends on the L dimension
- Options attached to the top CAPS or COATING

Client		Item <b>60-YTR-d-L</b>		
Delivery		DWG No.		Date 2020/06/01
	Appd. 西野	Drawn 中岡	Material	Qty.
			<b>Namitakiko Co.,Ltd.</b>	



# LS Anchor

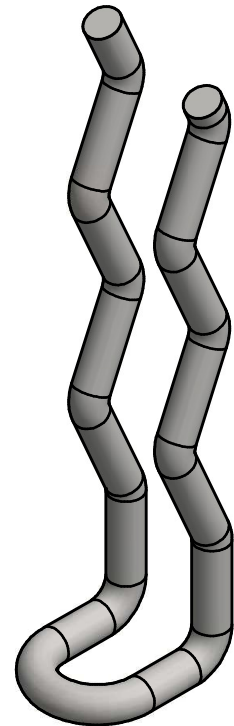
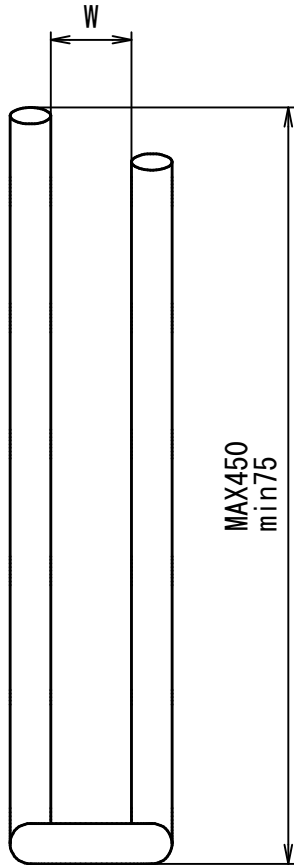

## Note

- The number of bends of the waves depends on the L dimension
- Options attached to the top CAPS or COATING

Client		Item LS-d-L			
Delivery		DWG No.		Date 2020/06/01	
	Appd. 西野	Drawn 中岡	Material	Qty.	<b>Namitakiko Co.,Ltd.</b>



# LTS Anchor

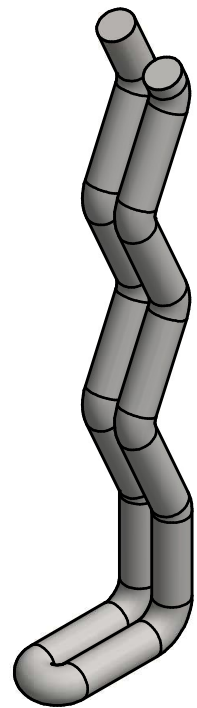
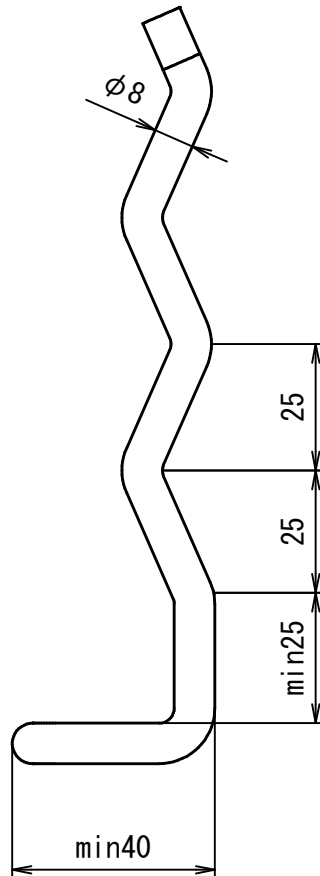
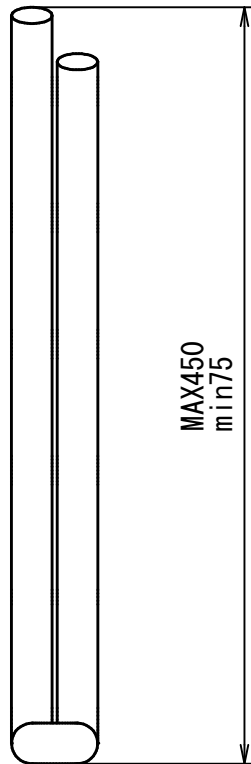

### Note

- The number of bends of the waves depends on the L dimension
- Options attached to the top CAPS or COATING

Client		Item LTS-d-L		
Delivery		DWG No.		Date 2020/06/01
	Appd. 西野	Drawn 中岡	Material	Qty.
		<b>Namitakiko Co.,Ltd.</b>		





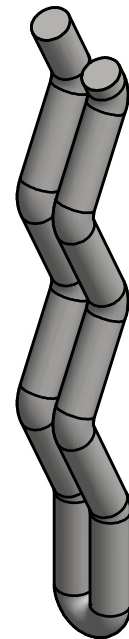
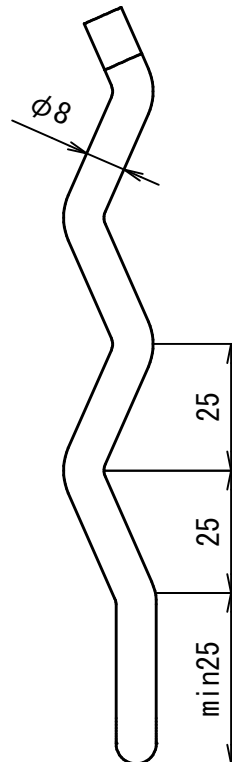
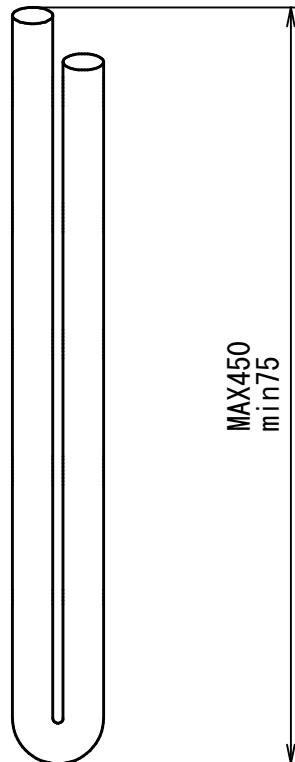

# TS Anchor

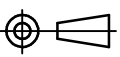

**Note**

- The number of bends of the waves depends on the L dimension
- Options attached to the top CAPS or COATING

Client				Item TS-d-L	
Delivery				DWG No.	
				Date 2020/06/01	
	Appd. 西野	Drawn 中岡	Material	Qty.	 <b>Namitakiko Co.,Ltd.</b>



# Stud Bolt

## Basic Type

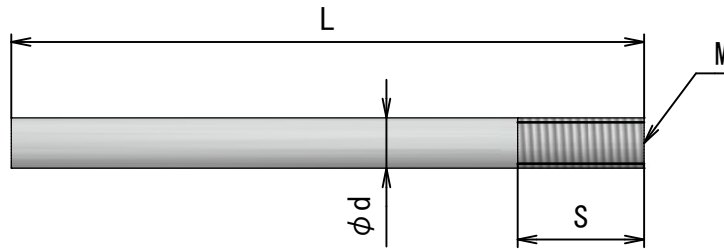

## Top Blade Type

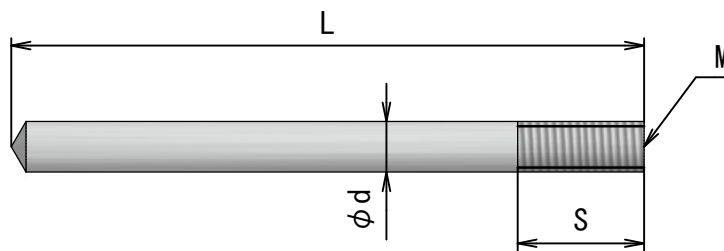

## Flux Type

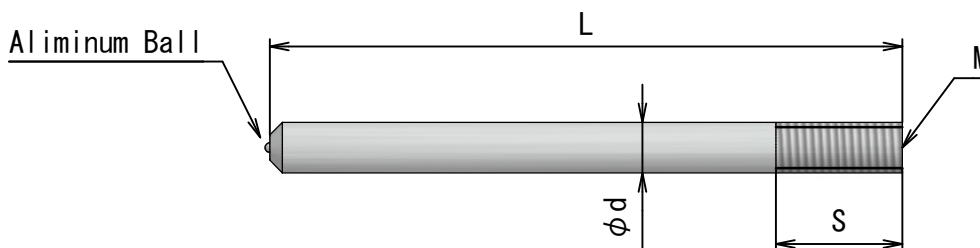

## Bending Type

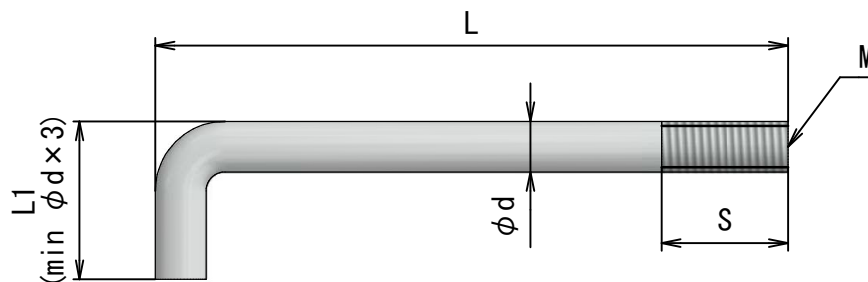

M	M6	M8	M10	M12
φd	φ5.3/φ6	φ7.1/φ8	φ8.9/φ10	φ10.8/φ12

Client		Item		
Delivery		DWG No.		Date 2020/06/01
	Appd. 西野	Drawn 中岡	Material	Qty.
		<b>Namitakiko Co.,Ltd.</b>		



# Stud Bolt (Type of Thread)

## Cut Thread

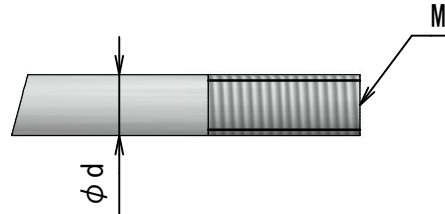

$\phi d$	M
$\phi 6$	M6
$\phi 8$	M8
$\phi 10$	M10
$\phi 12$	M12

## Rolled Thread

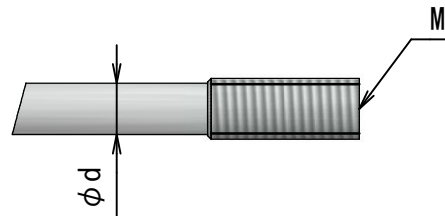

$\phi d$	M
$\phi 5.3$	M6
$\phi 7.1$	M8
$\phi 8.9$	M10
$\phi 10.8$	M12

Client		Item		
Delivery		DWG No.		Date 2020/06/01
	Appd. 西野	Drawn 中岡	Material	Qty.
		<b>Namitakiko Co.,Ltd.</b>		



# SBF / Ferrule

Flux type  
φ6~

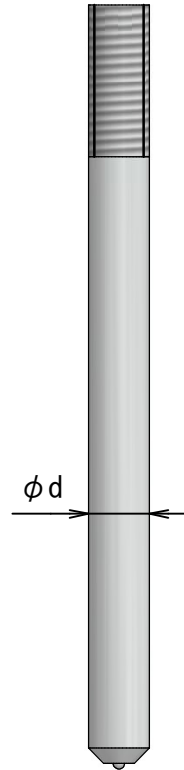

Top Blade type  
φ5.3, φ6

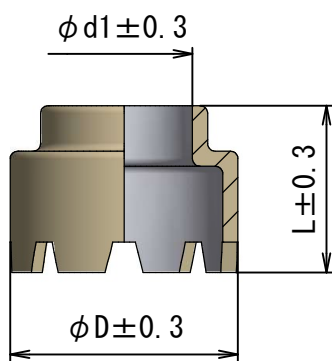
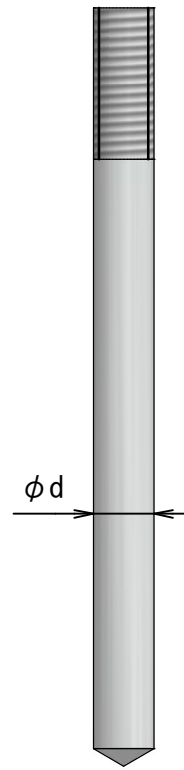

type	φd	φd1	φD	L
A	φ6	6.4	13	11
B	φ8	8.4	14.5	11
C	φ10	10.4	20	11
D	φ12	12.5	21	12

Client		Item		
Delivery		DWG No.		Date 2020/06/01
	Appd. 西野	Drawn 中岡	Material	Qty.
		<b>Namitakiko Co.,Ltd.</b>		



# YM1 / YM1S Anchor

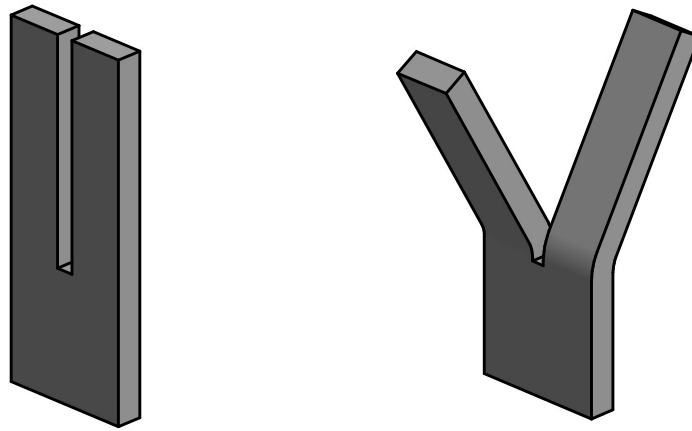

Can be delivered in both open or closed condition

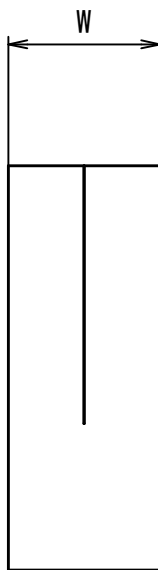

**YM1**  
Shaer type  
(Standard)

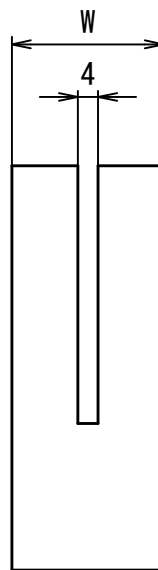

**YM1S**  
Slit type

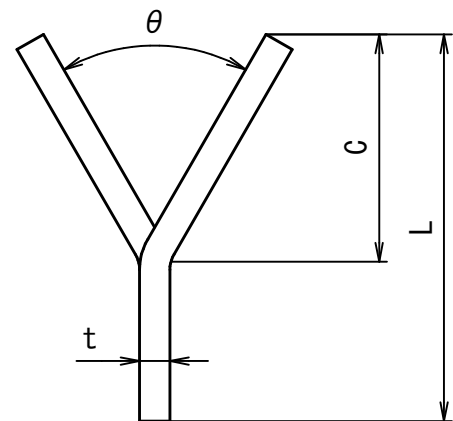

Client		Item		
		$\theta$ -YM1/YM1S-t-W-C-L		
Delivery		DWG No.		Date
				2020/06/01
	Appd. 西野	Drawn 中岡	Material	Qty.
<b>Namitakiko Co.,Ltd.</b>				



# Anchor Options

## CP : Attached Cap

- Shipping Style  
Attach to the anchor. Or separately

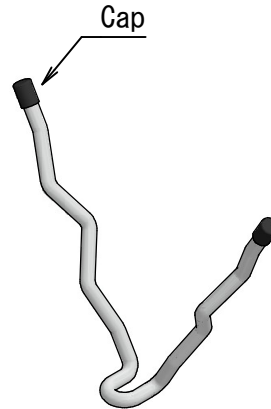

## NC : NAMI Color Coating

The standard length is 30 mm.  
You can choose the length.

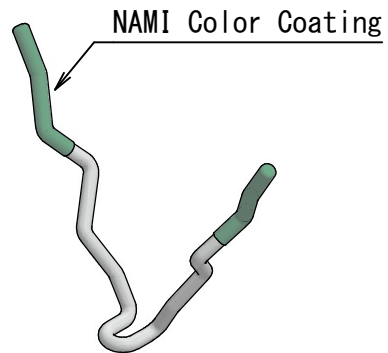

## Color Discrimination

Material	SS	SUS304	SUS309S	SUS310S	SUS316 - SUS316L
Color	● Black	● Yellow	● Red	● Green	● Blue

※) Our NAMI Color Coating uses the above colors as the standard.

## NT : Weld Nut

Standard welding is fillet welding

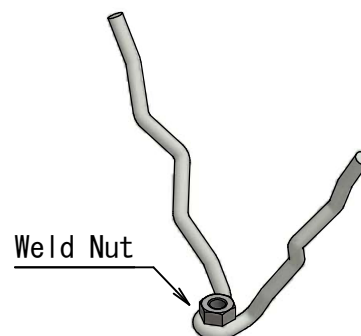

Client			Item		
Delivery			DWG No.		Date 2020/06/01
	Appd.	Drawn	Material	Qty.	<b>Namitakiko Co.,Ltd.</b>



# NAMI Color Coating Type

	Standard Type Tip, 30mm	Option		
		A Type	B Type	C Type
YM2A				
YM2B				
YM2C				

Material	SS	SUS304	SUS309S	SUS310S	SUS316 · SUS316L
Color		● Yellow	● Red	● Green	● Blue

※ Our NAMI Coating uses the above colors as the standard; non-colored coating is also producible.  
You can choose the number of coatings

Client				Item	
Delivery				DWG No.	
				Date 2020/06/01	
	Appd. 西野	Drawn 中岡	Material	Qty.	<b>Namitakiko Co.,Ltd.</b>



# Construction example

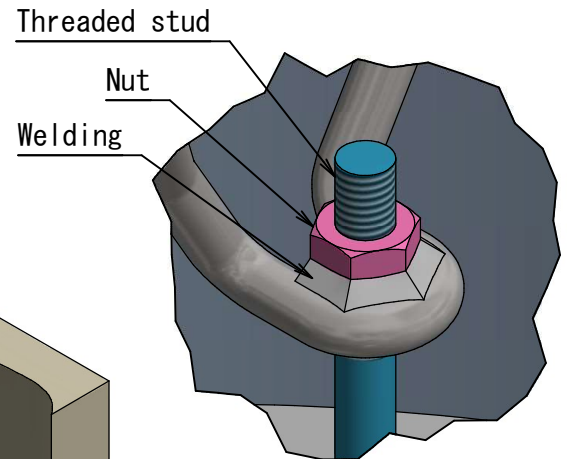
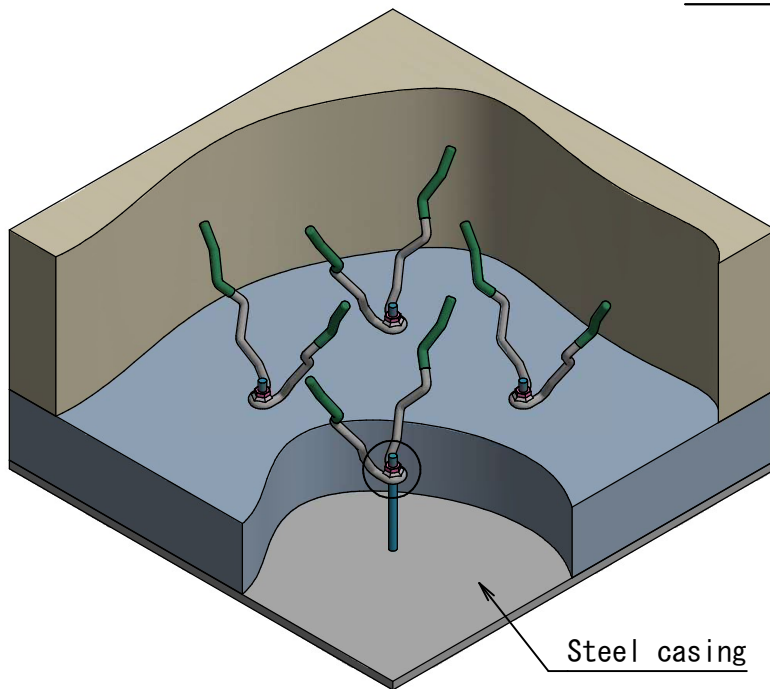
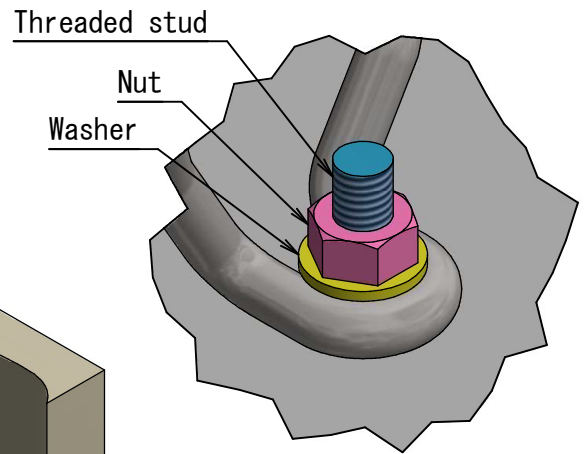
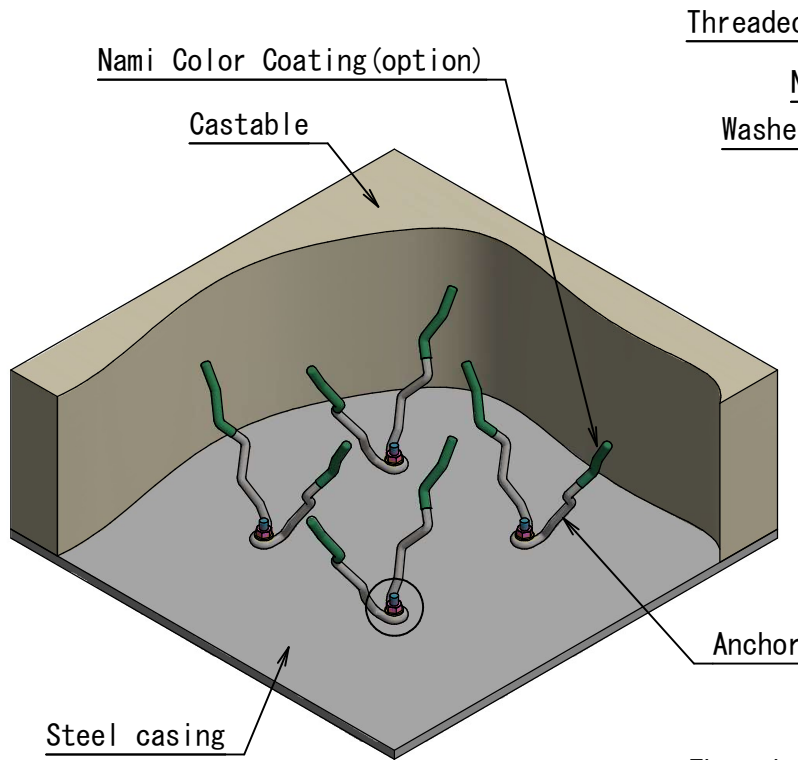

Client		Item			
Delivery		DWG No.		Date 2020/06/01	
	Appd. 西野	Drawn 中岡	Material	Qty.	<b>Namitakiko Co.,Ltd.</b>